

This package meets all zone requirements of NFPA 1901 specifications.

AERIAL PACKAGE 1

STROBE, LED AND ROTATING HALOGEN LIGHTING

ZONE A UPPER

Choose 1 of the options below

Zone Photometric Requirement- 1,000,000 CSM

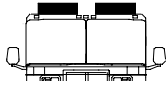

- Option 1** Two Model FNMINI Mini Edge® Ultra Freedom™ LED Lightbars, 24", clear outer lenses, mount straight or angled
- Option 2** Two Model 9MINNFPA 9M Mini Edge® Strobe Lightbars, 28-1/4", color outer lenses, mount straight or angled

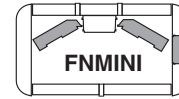
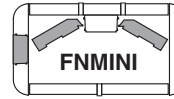

COLOR LEGEND
 □ Clear LEDs, Strobes or Lens
 □ Red LEDs or Lens

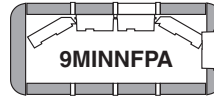
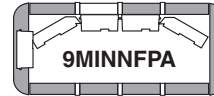

ZONE A LOWER

Choose 1 of the options below

Zone Photometric Requirement- 150,000 CSM

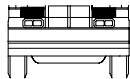

- Option 1** Two 40R020RR* 400 Series Linear8 Super-LED™ Lighthoods (red)
- Option 2** Two 402000RU* 400 Series Linear Strobe (red)
- Option 3** Two 50R03FRR* 500 Series TIR6 Super-LED™ (red)
- Option 4** Two 50R020RR* 500 Series Linear8 Super-LED™ (red)
- Option 5** Two 60R00FRR 600 Series LED Flasher Surface Mount (red)
- Option 6** Two 602000RU* 600 Series Linear Strobe Lighthoods (red)
- Option 7** Two 70R040RR 700 Series Linear8 Super-LED™ Lighthoods (red)
- Option 8** Two 70R00FRR 700 Series LED Flasher Surface Mount (red)
- Option 9** Two 702000RU 700 Series Linear Strobe Lighthoods (red)

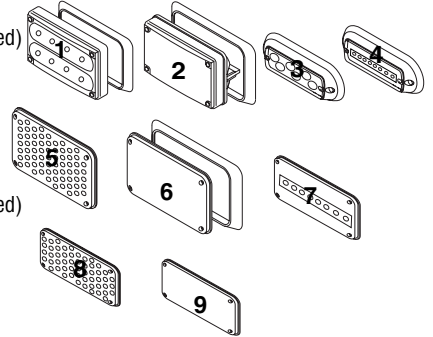

ZONE B UPPER

Zone Photometric Requirement- 400,000 CSM



Zone B Upper Front is covered by the lights from the Rear or Side of the Lightbar from Zone A upper
 Zone B Upper Rear is covered by One of the options chosen from Zone C Upper

ZONE B LOWER

Choose 1 of the options below

Zone Photometric Requirement- 150,000 CSM

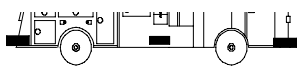

- Option 1** Two 40R020RR* 400 Series Linear8 Super-LED™ Lighthoods (red)
- Option 2** Two 402000RU* 400 Series Linear Strobe (red)
- Option 3** Two 50R03FRR* 500 Series TIR6 Super-LED™ (red)
- Option 4** Two 50R020RR* 500 Series Linear8 Super-LED™ (red)
- Option 5** Three 58EC20RU 508E Series Linear Strobe Surface Mount Strobe Lighthoods (red)
- Option 6** Two 60R00FRR 600 Series LED Flasher Surface Mount (red)
- Option 7** Two 602000RU* 600 Series Linear Strobe Lighthoods (red)
- Option 8** Two 70RCSFDR 700 Series LED Flashing Surface Mount (split red/white) Plus One 70R00FRR 700 Series LED Flashing Surface Mount (red)
- Option 9** Two 70R040RR 700 Series Linear8 Super-LED™ Lighthoods (red)
- Option 10** Two 70R00FRR 700 Series LED Flasher Surface Mount (red)
- Option 11** Two 702000RU 700 Series Linear Strobe Lighthoods (red)

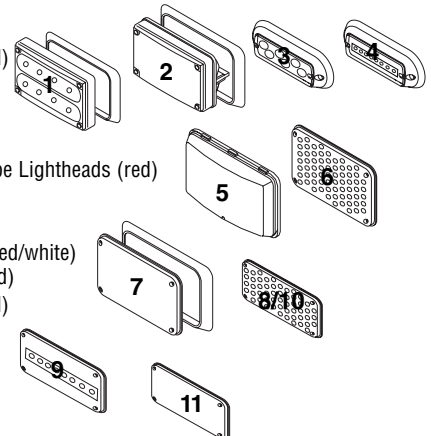

*Requires optional flange purchased separately

Note: Underscored model numbers indicate need for remote LED ballast.

AERIAL PACKAGE 1 (cont.)

FORM# N0497-1

STROBE, LED AND ROTATING HALOGEN LIGHTING

ZONE C UPPER

Choose 1 of the options below

Zone Photometric Requirement- 800,000 CSM

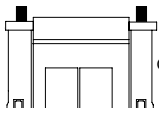

Option 1, 2, 3, 4, 7, 8

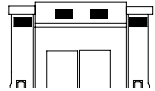

Option 5, 6

- Option 1** One RB6TAP and one RB6TRP RB6 Series Rotating Beacons (one amber, one red)
- Option 2** Two RB6TRP RB6 Series Rotating Beacons (red)
- Option 3** Two B6TLRR1P RBT Series Upper Rotator, Lower Level, LED with flasher (red)
- Option 4** Two B6TSRR1P RBT Series Upper Rotator, Lower Level, Strobe (red)
- Option 5** Four 40R020RR* 400 Series Linear8 Super-LED™ Lightheads (red)
- Option 6** Four 70R040RR 700 Series Linear8 Super-LED™ Lightheads (red)
- Option 7** Two MCFLED2R Micro Edge® Ultra Freedom LED Lightheads (red)
- Option 8** Two MCSLED2R Micro Edge® LFL Liberty LED Lightheads (red)

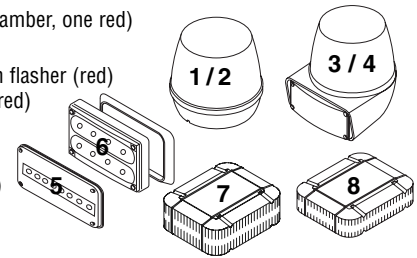

ZONE C LOWER

Choose 1 of the options below

Zone Photometric Requirement- 150,000 CSM

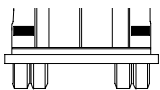

- Option 1** Two 40R020RR* 400 Series Linear8 Super-LED™ Lightheads (red)
- Option 2** Two 402000RU* 400 Series Linear Strobe (red)
- Option 3** Two 50R03FRR* 500 Series TIR6 Super-LED™ (red)
- Option 4** Two 50R020RR* 500 Series Linear8 Super-LED™ (red)
- Option 5** Two 60R00FRR 600 Series LED Flasher Surface Mount (red)
- Option 6** Two 602000RU* 600 Series Linear Strobe Lightheads (red)
- Option 7** Two 70R040RR 700 Series Linear8 Super-LED™ Lightheads (red)
- Option 8** Two 70R00FRR 700 Series LED Flasher Surface Mount (red)
- Option 9** Two 702000RU 700 Series Linear Strobe Lightheads (red)

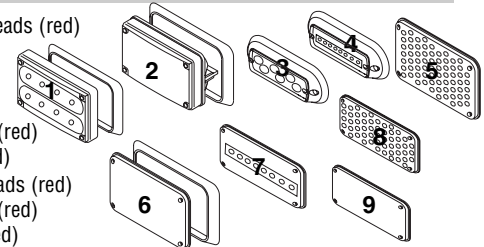

ZONE D UPPER

Zone Photometric Requirement- 400,000 CSM

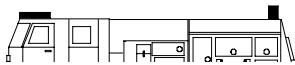

Zone D Upper Front is covered by Light from the Rear or Side of Lightbar from Zone A upper
Zone D Upper Rear is covered by One of the options chosen from Zone C Upper

ZONE D LOWER

Choose 1 of the options below

Zone Photometric Requirement- 150,000 CSM

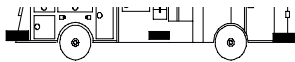

- Option 1** Two 40R020RR* 400 Series Linear8 Super-LED™ Lightheads (red)
- Option 2** Two 402000RU* 400 Series Linear Strobe (red)
- Option 3** Two 50R03FRR* 500 Series TIR6 Super-LED™ (red)
- Option 4** Two 50R020RR* 500 Series Linear8 Super-LED™ (red)
- Option 5** Three 58EC20RU 508E Series Linear Strobe Surface Mount Strobe Lightheads (red)
- Option 6** Two 60R00FRR 600 Series LED Flasher Surface Mount (red)
- Option 7** Two 602000RU* 600 Series Linear Strobe Lightheads (red)
- Option 8** Two 70R040RR 700 Series Linear8 Super-LED™ Lightheads (red)
- Option 9** Two 70R00FRR 700 Series LED Flasher Surface Mount (red)
- Option 10** Two 70RCSFDR 700 Series LED Flashing Surface Mount (split red/white)
Plus One 70R00FRR 700 Series LED Flashing Surface Mount (red)
- Option 11** Two 702000RU 700 Series Linear Strobe Lightheads (red)

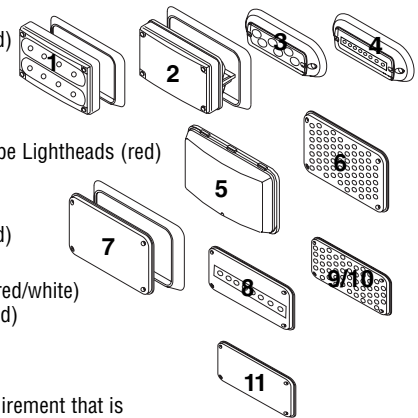

Note: Choosing one of the options listed in each zone is the minimum zone requirement that is needed to meet the NFPA 1901 Standard for Automotive Fire Apparatus 1999 Edition, Table 11-8 12.4 (Minimum Optical Power Requirements for Apparatus). If additional lighting is needed to meet lower zone distance requirements only, you can use any of our warning lightheads shown on pages 33, 34, or 35 of this brochure.

*Requires optional flange purchased separately
Note: Underscored model numbers indicate need for remote LED ballast.

See inside cover of this booklet to CHOOSE an NFPA approved Strobe Power Supply or a Halogen Flasher.
See Amp Draw Charts on pages 36 and 37 for overall amperage consumption.
Some LED lightheads have internal flasher module and do not need a flasher unless a specific flash sequence is needed.
Underscored LED lightheads need a remote ballast to operate.

CERTIFICATE OF COMPLIANCE WITH NFPA 1901

To Meet Certification, Check Box for the Option Chosen in Each Appropriate Zone

Note: This system is tested and certified by Whelen Engineering Company, Inc. to meet all requirements for the NFPA 1901 Standards for Automotive Fire Apparatus (1999 Edition). See Chapter 11 titled: Low Voltage Electrical Systems & Warning Devices. This System is Certified only if all optical and electrical warning devices are installed and wired in accordance to the 1901 Standard and Specifications; and also in accordance to the device manufacturers mounting and wiring specifications.

FIRE DEPARTMENT _____
TRUCK NUMBER _____