

BILL OF MATERIAL

ITEM	QTY	PART NO	DESCRIPTION
1	3	550194	16-14 AWG FEMALE DISCONNECT
2	1	550195-3	16-14 AWG RING TONGUE TERMINAL
3	1	550197-1	3 CONDUCTOR WIRE

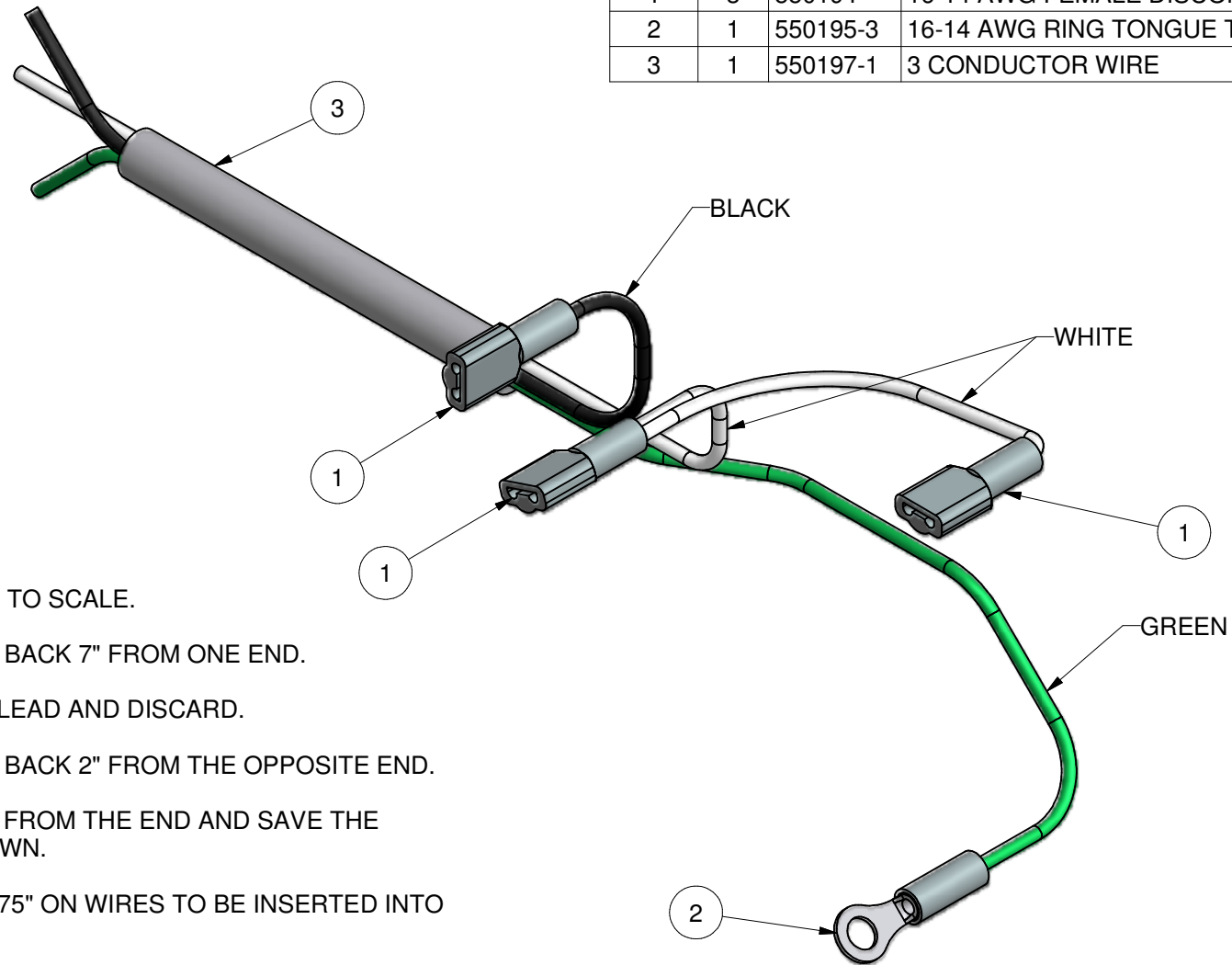

NOTES:

1. WIRE LENGTH NOT SHOWN TO SCALE.
2. STRIP THE OUTER SHEATH BACK 7" FROM ONE END.
3. CUT 4" OFF OF THE BLACK LEAD AND DISCARD.
4. STRIP THE OUTER SHEATH BACK 2" FROM THE OPPOSITE END.
5. CUT THE WHITE LEAD 3.75" FROM THE END AND SAVE THE CUT-OFF TO BE USED AS SHOWN.
6. STRIP INSULATION BACK .375" ON WIRES TO BE INSERTED INTO TERMINALS.
7. INSERT WIRES INTO TERMINALS AND CRIMP.

01	1128	MKP	1/9/03
REV.	ECN NO	REV. BY	REV. DATE
ENGRG. CHANGE NOTICE			



**SUSPENSION TECHNOLOGY, INC.**

1510 METRIC AVE. S.W. CANTON, OHIO 44706  
 PHONE (888) 877-3058 FAX (330) 458-3066

MATERIAL

UNLESS OTHERWISE SPECIFIED,  
 ALL DIMENSIONS ARE IN INCHES

STANDARD TOLERANCES  
 UNLESS SPECIFIED

X.X ± .06    FRAC ± 1/16  
 X.XX ± .03  
 X.XXX ± .01    ANGLE ± 1

WEIGHT

DRAWN BY  
**M. Powers**

CHECKED BY

SCALE

1:1

RELEASE DATE

1/9/2003

DATE

9/4/2002

DATE

TITLE

**PANEL WIRE  
 ASSEMBLY**

THIRD ANGLE PROJECTION

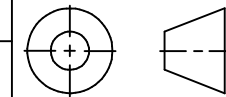

SIZE

A

DRAWING NUMBER

550198

THIS DRAWING IS THE PROPERTY OF SUSPENSION TECHNOLOGY, INC. AND IS LOANED UPON CONDITION THAT IT IS NOT TO BE REPRODUCED OR COPIED, IN WHOLE OR IN PART, OR USED FOR FURNISHING INFORMATION TO ANY PERSON WITHOUT THE WRITTEN CONSENT OF SUSPENSION TECHNOLOGY, INC. AND ALL COPIES ARE TO BE RETURNED UPON REQUEST.