

POWERING POSSIBILITIES

Reliable Power Conversion Products & Accessories

THE ALL-NEW Intelli-Power 1000 Watt Pure Sine Inverter



www.progressivedyn.com

Progressive
Dynamics, Inc.



Why Progressive? What we offer

Recreational Vehicle Products

Recreational Vehicle power conversion and battery charging products enhanced by our **Charge Wizard® 4-stage battery management system**. This management system constantly monitors voltage status and automatically manages your battery. Accessories are also available.

Specialty Products

Specialty products from Progressive Dynamics, Inc. are suited for various specialty vehicles and other applications for a range of industries.

Marine Products

A complete range of Marine battery chargers from 20 to 80 Amps. Features a digital display screen, plus a unique microprocessor controlled four-stage charging system that offers rapid recharge and two to three times longer battery life.

About Progressive Dynamics, Inc.

Progressive Dynamics, Inc. is a privately owned corporation, established in Marshall, Michigan, in 1964. Its initial product was a high-quality LP gas regulator manufactured for use in recreational vehicle heating and cooking systems.

Today, PDI produces a full line of products for the RV, marine and specialty industry. No matter the product, at PDI you receive superior quality and customer service. Our product's are designed, assembled, tested, warranted and serviced in the U.S.A.



Product Index OEM & Retail

| RV | Page |
|--|-------|
| Charge Wizard/PDI Plus Lifetime Extended Warranty | 6 |
| Inteli-Power 4000 Series Converter/Chargers..... | 7 |
| Inteli-Power 4100 AC/DC Power Distribution Panel/Converter | 8 |
| Inteli-Power 4500 Series Converter/Chargers..... | 9 |
| Inteli-Power 4600 Series Converter/Chargers..... | 10 |
| 4600 Series Lithium Converter/Charger Upgrades..... | 11 |
| Inteli-Power 9200 Series Converter/Chargers..... | 12-13 |
| Inteli-Power 9100 Series Converter/Chargers..... | 14-15 |
| 5000 Series AC/DC 120 VAC Power Distribution Panel..... | 16 |
| 5500 Series AC/DC 240 VAC Power Distribution Panel..... | 17 |
| 6000 Series DC Power Distribution Panel..... | 18 |
| 5100 & 5200 Series Automatic Transfer Switches..... | 19 |
| RV Converter Crossover List..... | 24 |
| Replacement Lenses for RV Ceiling Lights..... | 25 |

| SPECIALTY PRODUCTS | Page |
|--|-------|
| 5300 Series Automatic Transfer Switch | 21 |
| 24 Volt Power Converter/Charger Battery Charger..... | 21 |
| Inteli-Power 9100L Series Converters for Lithium Batteries | 22-23 |
| Inteli-Power Converters for Lithium Batteries - Wall Mount Series..... | 23 |

MARINE

| | |
|---|-------|
| Inteli-Power 2100 Series Electronic Converter/Chargers..... | 26-27 |
|---|-------|

Product specifications are subject to change without notice.



Manufactured and
Served in the USA

COMING IN 2019!

THE ALL-NEW Intelli-Power 1000 Watt Pure Sine Inverter



INVERTER FEATURES

- **Reverse battery protection**
- Thermally controlled fan speed
- Unit can be monitored by remote control
- Auto Restart after power interrupt
- Easy AC hardwire hookup
- Remote sold separately
- Conforms to UL STD 458, Certified to CSA STD C22.2 No. 107.1
- Units available with built-in GFCI or without
- DC lug connection
- Unit weight: 10 lbs
- Unit dimensions: 11.6 x 9.46 x 4.07
- 1,000 watt continuous power
- 2,000 watt peak power



Since 1964, Progressive Dynamics, Inc. has been the source of bright ideas for the Recreational Vehicle and Marine Industries

MAKING A DIFFERENCE THROUGH INNOVATION AND DEPENDABILITY

Progressive Dynamics *Core Values*

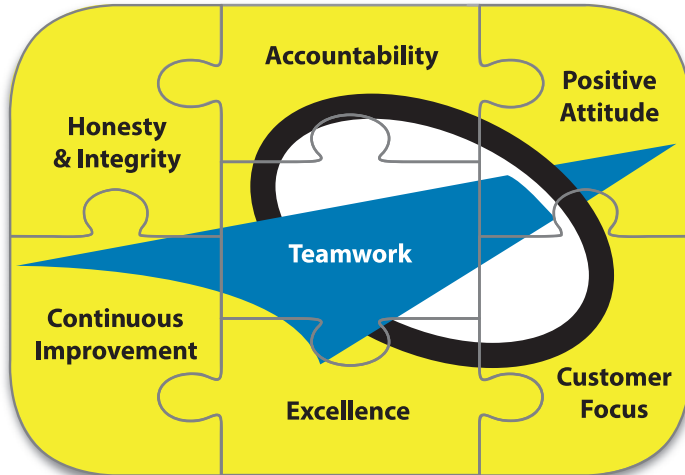

Service Department

507 Industrial Road
Marshall, MI 49068

Telephone: 269-781-4242

Service Dept. Fax: 269-781-8729

E-mail: service@progressivedyn.com

Service Hours: 8:30 A.M. to 4:30 P.M. Eastern Standard Time



Manufactured and
Served in the USA

Warranties and Refunds

- LIMITED WARRANTY:** Progressive Dynamics, Inc. warrants its products to be free from defects in material or workmanship under normal use and service; and limits the remedies to repair or replacement.
- DURATION:** This warranty is valid only within North America and shall extend from the original date of retail purchase for the period specified below.
Marine Battery Chargers: 2 Years; Power Converters: 2 Years;
Distribution Panels: 2 Years; Transfer Relays: 1 Year;
- WARRANTY EXCLUSIONS:** This warranty specifically does not apply to:
 - Any product which has been repaired or altered in any way by an unauthorized person or service station;
 - Damage caused by excessive input voltage, misuse, negligence or accident; or an external force;
 - Any product which has been connected, installed or adjusted or used other than in accordance with the instructions furnished, or has had the serial number altered, defaced or removed;
 - Cost of all services performed in removing and reinstalling the product; and
 - ANY LOST PROFITS, LOST SAVINGS, LOSS OF USE OF ENJOYMENT OR OTHER INCIDENTAL DAMAGES ARISING OUT OF THE USE OF, OR INABILITY TO USE, THE PRODUCT. THIS INCLUDES DAMAGES TO PROPERTY AND, TO THE EXTENT PERMITTED BY LAW, DAMAGES FOR PERSONAL INJURY.
 THIS WARRANTY IS IN LIEU OF ALL OTHER WARRANTIES, INCLUDING IMPLIED WARRANTIES OF MERCHANTABILITY AND FITNESS FOR A PARTICULAR PURPOSE.
- PROOF OF PURCHASE:** A warranty claim must be accompanied by proof of the date of purchase. This may be in the form of a dealer Bill-of-Sale/Invoice, store receipt, or new vehicle title. No prior registration of the converter is necessary to start the standard warranty.
- CLAIM PROCEDURE:** Upon discovery of any defect, Progressive Dynamics, Inc. shall be supplied the following information by mail, telephone, fax or email.
 - Name and address of the claimant;
 - Name, model and serial number of the product;
 - Date of purchase; and
 - Complete description of the claimed defect.
 E. Recreational Vehicles: Application in which product was installed.
(Includes manufacturer, model and model year where applicable)
F. Marine Craft: Application in which product was installed.
(Includes manufacturer, model and model year where applicable)

Upon determination that a warranty claim exists (a defect in material or workmanship occurring under normal use and service,) the product shall be shipped postage prepaid to Progressive Dynamics, Inc. together with proof of purchase. The product will be repaired or replaced and returned postage prepaid.

See our website for current information, manuals, troubleshooting, installation, and product specifications:

www.progressivedyn.com



CHARGE WIZARD®

Tired of Replacing Batteries?

DON'T LET THIS HAPPEN TO YOUR CUSTOMERS!

Customer complaints are “history” when installing a Progressive Dynamics converter with the automatic 4-stage Charge Wizard® system. The Charge Wizard has been shown to increase battery life by 2 to 3 times or more.

Our Charge Wizard 4-stage system uses microprocessor technology to add intelligent charging capability. It constantly monitors the battery and automatically adjusts the converter output voltage based on the battery's charge status – designed to eliminate battery over & under charging problems associated with most other battery chargers and provide rapid yet safe battery recharging.

The Charge Wizard constantly monitors battery voltage and battery usage then selects one of the following four operating modes to properly charge and maintain the battery.

BOOST Mode

14.4 Volts – Rapidly brings the battery up to 90% of full charge.

NORMAL Mode

13.6 Volts – Safely completes the charge.

STORAGE Mode

13.2 Volts – Maintains charge with minimal gassing or water loss.

EQUALIZATION Mode

14.4 Volts – Every 21 hours for a period of 15 minutes helps prevent battery stratification & sulfation — the leading cause of battery failure.



The Charge Wizard technology is built into our PD4000, PD4100, PD4500, PD4600 and PD9200 series converters/chargers. The Charge Wizard is also available as a pendant (as shown on the right). This allows easy field upgrade to your PD9100 series deck mount converter/charger by simply plugging the pendant into the built-in TCMS® connector located just above the fuses on the output panel.

Retail Models:

PD9105V for charging flooded lead-acid and AGM batteries

OEM Models:

PD9105 for charging flooded lead-acid and AGM batteries

Retail Display Package

Colorful graphics grab attention and the large window shows the product. The package is designed for pegboard or slatwall display.

See our website for Charge Wizard demonstration:
www.progressivedyn.com



PDI PLUS LIFETIME EXTENDED WARRANTY

Your converter is covered by a two year limited warranty against defects in material or workmanship. This standard warranty begins on the date of the original purchase of your recreational vehicle\boat.

You can **EXTEND THE LIMITED TWO YEAR WARRANTY** on your converter for **PDI PLUS LIFETIME WARRANTY** for an additional charge by registering your converter.

LEARN MORE AT
progressivedyn.com

RV Converter/Chargers with built-in Charge Wizard®

INTELI-POWER® 4000 SERIES

"MIGHTY MINI" THE COMPACT ALL-IN-ONE SYSTEM...
AC/DC DISTRIBUTION PANEL AND INTELI-POWER CONVERTER.

Features:

Industry's smallest all-in-one 45 or 60 Amp distribution panel/converter system. Available with our exclusive built-in Inteli-Power Converter...

"The most reliable converter in the RV industry."

The converter section is easily accessible from the front.

AC Distribution Panel is rated for 120 VAC @ 30 Amps with up to 7 branch circuits.

The DC section has 12 branch fuse holders, two wired to accommodate 30 Amp fuses, ten more with a maximum rating of 20 Amps each. All wire tail connections.

Exclusive DC disconnect tie in.

Reverse battery blown fuse indicator.

Retail Models:

PD4045KV & PD4060KV

Other Features:

- Compact & lightweight
- Reverse battery protection with easy to replace fuses
- Electronic current limiting
- High and low AC input protection
- Intelligent, variable speed, cooling fan
- Automatic thermal protection
- Front access to large wiring compartment
- Snap-lock cover stays shut while traveling – opens with a touch
- Attractive lightweight panel design made from black impact-resistant high temperature polymers.

Specifications:

Panel Dimensions: 12.28"W x 8.875"H x 7.25"D

Cutout Size: 10.75"W x 7.25"H

Weight: 45 Amp Model, 5.6 lbs.; 60 Amp Model, 6.2 lbs.

Replacement Converter Section:

Model PD4045CSV, Weight: 3.0 lbs.

Model PD4060CSV, Weight: 4.0 lbs.

PD4045KA Converter

Input: 105-130VAC 50/60Hz 725 Watts

Output: 13.6VDC 45 Amps

PD4060K Converter

Input: 105-130VAC 50/60Hz 1,000 Watts

Output: 13.6VDC 60 Amps



Built-in Charge Wizard constantly monitors voltage status and automatically manages your battery. Inteli-Power 4000 Mighty Mini models can recharge the battery to 90% in 3-6 hours using our Charge Wizard technology.



PD4060K



PD4045KA



PD4060



Manufactured and Serviced
in the USA



AC/DC Distribution Panel/Converter with built-in Charge Wizard®

INTELI-POWER® 4100

COMPACT ALL-IN-ONE-SYSTEM...
DIRECT REPLACEMENT FOR WFCO 8735!

Features:

Available with our exclusive built-in Intelli-Power Converter...

"The most reliable converter in the RV industry."

The converter section is easily serviceable. The AC Distribution Panel is rated for 120 VAC @ 30 Amps with up to 5 branch circuits.

The DC section has 6 branch fuse holders. Retail model includes all wire tails for ease of installation. OEM models have 1/4" tab connectors.

LED indicators identify which fuse is blown.

Easy access to reverse battery protection fuse.

Replaceable converter section.

Specifications:

Panel Dimensions: 11.25"W x 8"H x 3.8"D

Cutout Size: 10.25"W x 7.0"H

Weight: 3.8 lbs.

Retail model PD4135KW2 Input: 105-130VAC 50/60HZ
725 Watts

Output: 13.6VDC 35 Amps

DC rating 1-40A, 1-30A, 4-20A fuse holders

OEM model PD4135KW2B

Input: 105-130VAC 50/60HZ 725 Watts

Output: 13.6VDC 35 Amps

DC rating 1-40A, 1-30A, 4-20A fuse holders

OEM model PD4135K2 (with wires)

Input: 105-130VAC 50/60HZ 725 Watts

Output: 13.6VDC 35 Amps

DC rating 1-40A, 1-30A, 4-20A fuse holders



Built-in Charge Wizard constantly monitors voltage status and automatically manages your battery. Intelli-Power 4100 Series models can recharge the battery to 90% in 3-6 hours using our Charge Wizard technology.



Manufactured and Serviced
in the USA



RV Converter/Chargers with built-in Charge Wizard®

INTELI-POWER® 4500 SERIES

THE ULTIMATE ALL-IN-ONE 240V INPUT VOLTAGE,
50 AMP AC/DC DISTRIBUTION PANEL

Inteli-Power AC Features:

The AC Distribution Panel is rated for 240V input voltage at 50 Amps.

Provisions for up to 12 branch circuit breakers plus a center feed dual 50 Amp main breaker (not included).

12 built-in push and lock strain relief wiring connectors make installation quick and easy and saves over 50% on installation costs.

Attractive lightweight panel design made from black impact-resistant high temperature polymers.

Inteli-Power DC Features*:

Top ten fuse holders recommended for low current devices such as smoke and carbon monoxide detectors.

Optional 12 branch fuse holders with 2-30 Amp circuits or 18 branch fuse holders with 4-30 Amp circuits. Maximum rating 20 Amps on remaining circuits — available with optional wire tail connections.

Optional LED indicators identify which fuse is blown.

Converter/Charger section is accessible from the front.

Converter/Charger ratings of 60, 75 and 90 Amps which is the largest rating available in the industry.

Easy access reverse battery protection fuses.

Optional DC disconnect tie in.

Other Features:

- Reverse battery protection
- Electronic current limiting
- High and Low AC input protection
- Intelligent, variable speed, cooling fan
- Automatic thermal protection
- Press open door for easy access to circuit breakers
- Front access to large wiring compartment
- Optional DC Ground Buss can be user installed in the DC wiring compartment.

Specifications:

Panel Dimensions: 11.85"W x 14.125"H x 7.80"D

Cutout Size: 10.125"W x 13.25"H

Weight: 60 Amp Model, 8 lbs., 75 Amp Model, 8.5 lbs., 90 Amp Model, 10 lbs.

Replacement Converter Section:

Model PD4560CSV, Weight: 5.25 lbs.

Model PD4575CSV, Weight: 5.5 lbs.

Model PD4590CSV, Weight: 6.1 lbs.

PD4560 Converter

Input: 105-130VAC 50/60HZ 1000 Watts

Output: 13.6VDC 60 Amps

PD4575 Converter

Input: 105-130VAC 50/60HZ 1300 Watts

Output: 13.6VDC 75 Amps

PD4590 Converter

Input: 105-130VAC 50/60HZ 1550 Watts

Output: 13.6VDC 90 Amps

**Customer must supply options when ordering.*



Built-in Charge Wizard constantly monitors voltage status and automatically manages your battery. Inteli-Power 4500 Series models can recharge the battery to 90% in 3-6 hours using our Charge Wizard technology.



Manufactured and Serviced
in the USA



RV Converter/Chargers with built-in Charge Wizard®

INTELI-POWER® 4600 SERIES

UPGRADE OR REPLACEMENT FOR MANY
RV POWER CENTER CONVERTER/CHARGERS

Features:

Charge Wizard 4-Stage charging system built-in dramatically increases battery life.

This converter/charger will not boil the battery!

55 Amp (PD4655V), 45 Amp (PD4645V) and 35 Amp (PD4635V) models available.

The intelligent way to charge & maintain your battery.

Easy to install.

Specifications:

Dimensions: 13.25"W x 8"D x 5.38"H

Weight: 35 & 45 Amp Models, 9 lbs. ; 55 Amp Model, 10 lbs.

Inteli-Power 55 Amp Converter/Charger

Model #PD4655V replaces these converter sections:

Parallax/Magnatek #6355, Parallax #7355, Parallax #8355, Parallax #7155, WFCO™ #8955

Inteli-Power 45 Amp Converter/Charger

Model #PD4645V replaces these converter sections:

Parallax/Magnatek #6345, Parallax #7345, Parallax #8345, WFCO™ #8945

Inteli-Power 35 Amp Converter/Charger

Model #PD4635V replaces these converter sections:

Parallax/Magnatek #6336, WFCO™ #8935

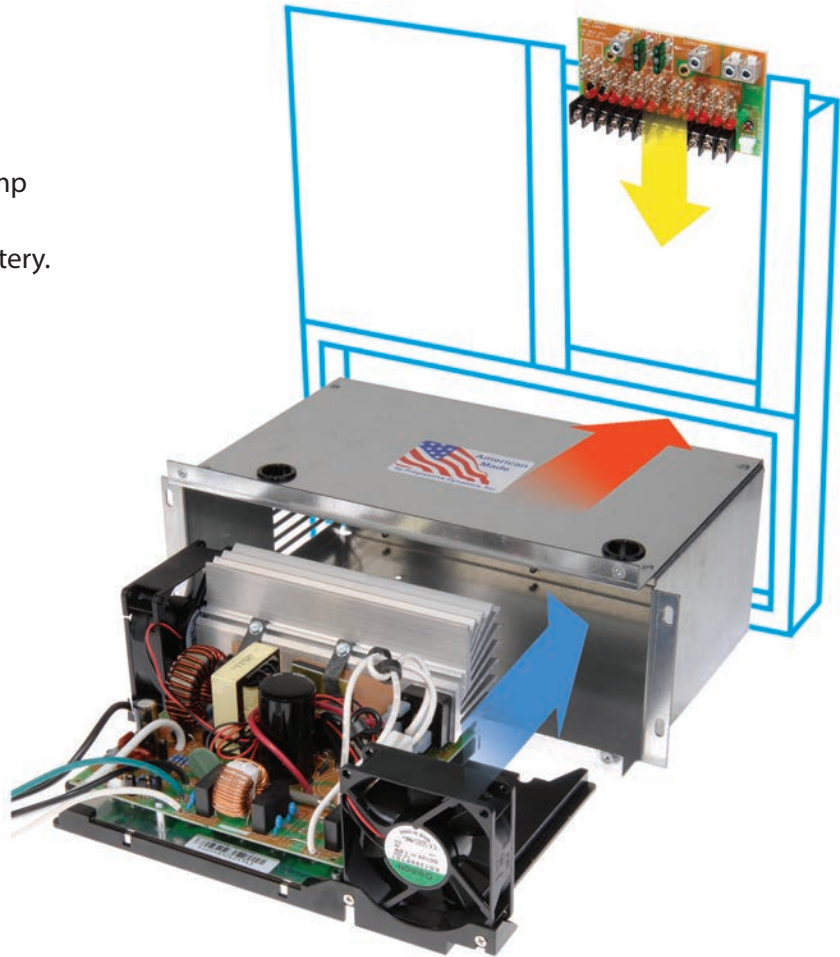

Built-in Charge Wizard constantly monitors voltage status and automatically manages your battery. Inteli-Power 4600 Series models can recharge the battery to 90% in 3-6 hours using our Charge Wizard technology.



Manufactured and Serviced
in the USA



A metal enclosure is included in every package for replacement Parallax/Magnatek 6300 Series, 7300 Series or 8300 Series Converter.

RV Converter/Chargers with built-in Charge Wizard®

INTELI-POWER® 4600 SERIES LITHIUM

UPGRADE YOUR RV
TO LITHIUM BATTERY POWER

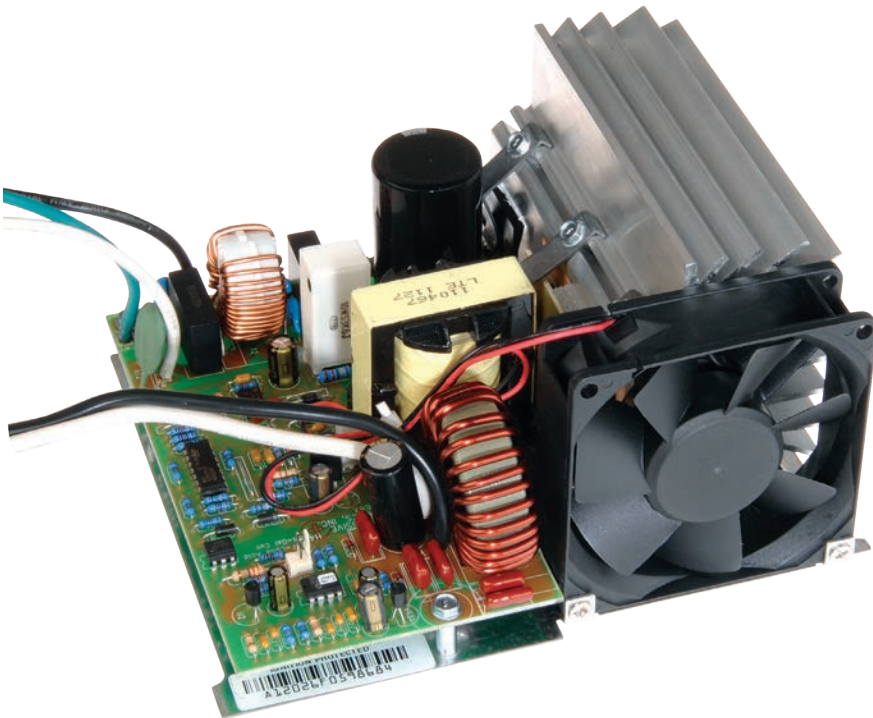

Store 3-4 Times
the Energy of a
Lead/Acid Battery!

Progressive Dynamics Now Offers Lithium Upgrades for PDI Converter/Chargers

Lithium replacement converter sections for WFCO:

PD4635LIV replaces WFCO 8935

PD4645LIV replaces WFCO 8945

PD4655LIV replaces WFCO 8955



All models feature our 2-year
"No Hassle" warranty.



Manufactured and Serviced
in the USA



12 Volt Converter/Chargers with built-in Charge Wizard®

INTELI-POWER® 9200 SERIES

ALL MODELS AVAILABLE FOR LEAD-ACID OR AGM BATTERIES,
ENGINEERED FOR POWER-HUNGRY APPLICATIONS

The built-in Charge Wizard automatically selects one of four operating modes:

BOOST, NORMAL, STORAGE, EQUALIZATION.

BOOST Mode

14.4 Volts – Rapidly brings the battery up to 90% of full charge.

NORMAL Mode

13.6 Volts – Safely completes the charge.

STORAGE Mode

13.2 Volts – Maintains charge with minimal gassing or water loss.

EQUALIZATION Mode

14.4 Volts – Every 21 hours for a period of 15 minutes helps prevent battery stratification & sulfation — the leading cause of battery failure.



Retail Model Pendant PD92201

Plugs into the accessory port to show charger/ converter status and allows for manual mode selection. The pendant is included with all retail models.



Built-in Charge Wizard constantly monitors voltage status and automatically manages your battery. Intel-Power 9200 Series models can recharge the battery to 90% in 3-6 hours using our Charge Wizard technology.



Charge Wizard pendant plugs into the accessory port located on the right side.



Standard features on all models:

- Equipped with 15 Amp electrical cord. (with the exception of the 80 Amp models)
- Built-in Charge Wizard constantly monitors voltage status and automatically manages your battery.
- Built-in accessory port for optional Pendant (standard on retail units) to monitor Charge Wizard operating modes.
- Reverse battery protection protects converter from damage resulting from improper (reverse) battery lead connection.
- These solid-state converter/chargers deliver filtered DC power to all 12 Volt lighting and appliance circuits providing safe and reliable service.
- Electronic current limiting automatically reduces output voltage when maximum capacity is reached. Protects your investment and offers peace of mind.
- Variable speed intelligent cooling fan automatically monitors converter temperature and activates fan at speed required. Very slow quiet speeds are used when demand is low such as during sleeping hours.
- High voltage protection protects converter from spikes or surge of voltage over 135V.
- Automatic thermal protection reduces converter output to safe levels when unit temperature exceeds pre-set limits and protects converter from damage due to excessive heat.
- 2 year limited warranty.

Retail Model PD9280AV*
OEM Model PD9280A*
 Input: 105-130 VAC, 50/60 Hz, 1300 Watts
 Output: 13.6 VDC, 80 Amp
 Dimensions: 11.65"L x 7.38"W x 3.6"H
 Weight: 7.5 lbs.

80 AMP



*Plugs into a 20 Amp outlet. Removal or alteration of converter 20 Amp power cord will void warranty.

Retail Model PD9270V
OEM Model PD9270
 Input: 105-130 VAC, 50/60 Hz, 1250 Watts
 Output: 13.6 VDC, 70 Amp
 Dimensions: 9.15"L x 7.38"W x 3.6"H
 Weight: 5.8 lbs.

70 AMP



Retail Model PD9260-CV
OEM Model PD9260-C
 Input: 105-130 VAC, 50/60 Hz, 1000 Watts
 Output: 13.6 VDC, 60 Amp
 Dimensions: 9.15"L x 7.38"W x 3.6"H
 Weight: 5.8 lbs.

60 AMP



Retail Model PD9245-CV
OEM Model PD9245-C
 Input: 105-130 VAC, 50/60 Hz, 725 Watts
 Output: 13.6 VDC, 45 Amp
 Dimensions: 8.25"L x 7.25"W x 4.7"H
 Weight: 4.5 lbs.

45 AMP



Electronic 12 Volt Converter/Chargers

INTELI-POWER® 9100 SERIES

THE 12 VOLT CONVERTER/CHARGERS OF CHOICE
BY LEADING MANUFACTURERS



Engineered for Power-Hungry Applications

30, 40, 45, 60, 70 & 80 Amp Models Available



TCMS Charge Wizard plugs
into the accessory port
located on the output panel.

Standard features on all models:

- Equipped with 15 Amp electrical cord except the 80 Amp model which has a 20 Amp Cord.
- Reverse battery protection protects converters from damage resulting from improper (reverse) battery lead connection.
- These solid-state converter/chargers deliver filtered DC power to all 12 Volt lighting and appliance circuits providing safe and reliable service.
- Electronic current limiting automatically reduces output voltage when maximum capacity is reached. Protects your investment.
- Variable speed intelligent cooling fan automatically monitors converter temperature and activates fan at speed required. Very slow quiet speeds are used when demand is low such as during sleeping hours.
- High voltage protection protects converter from spikes or surge of voltage over 135V.
- Automatic thermal protection reduces converter output to safe levels when unit temperature exceeds pre-set limits and protects converter from damage due to excessive heat.
- Built-in Total Charge Management System® (TCMS) connector accepts the optional Charge Wizard that constantly monitors voltage status and automatically manages your battery.
- 2 year limited warranty.



Manufactured and Serviced
in the USA



Retail Model PD9180AV*
OEM Model PD9180A*
 Input: 105-130 VAC,
 50/60 Hz, 1300 Watts
 Output: 13.6 VDC, 80 Amp
 Dimensions:
 11.65"L x 7.38"W x 3.6"H
 Weight: 7.5 lbs.



* Plugs into a 20 Amp outlet. Removal or alteration of converter 20 Amp power cord will void warranty.

**80
AMP**



Retail Model PD9170V
OEM Model PD9170
 Input: 105-130 VAC,
 50/60 Hz, 1250 Watts
 Output: 13.6 VDC, 70 Amp
 Dimensions:
 9.15"L x 7.38"W x 3.6"H
 Weight: 5.8 lbs.

**70
AMP**



Retail Model PD9160AV
OEM Model PD9160A
 Input: 105-130 VAC,
 50/60 Hz, 1000 Watts
 Output: 13.6 VDC, 60 Amp
 Dimensions:
 9.15"L x 7.38"W x 3.6"H
 Weight: 5.8 lbs.

**60
AMP**



Retail Model PD9145AV
OEM Model PD9145A
 Input: 105-130 VAC,
 50/60 Hz, 725 Watts
 Output: 13.6 VDC, 45 Amp
 Dimensions:
 8.25"L x 7.25"W x 4.5"H
 Weight: 4.5 lbs.

**45
AMP**



Retail Model PD9140AV
OEM Model PD9140A
 Input: 105-130 VAC,
 50/60 Hz, 600 Watts
 Output: 13.6 VDC, 40 Amp
 Dimensions:
 8.25"L x 7.25"W x 4.7"H
 Weight: 4.5 lbs.

**40
AMP**



Retail Model PD9130V
OEM Model PD9130
 Input: 105-130 VAC,
 50/60 Hz, 500 Watts
 Output: 13.6 VDC, 30 Amp
 Dimensions:
 8.25"L x 7.25"W x 4.7"H
 Weight: 4 lbs.

**30
AMP**



Plug in a Charge Wizard

Provides rapid battery recharge for dry campers. The intelligent way to automatically charge batteries! TCMS® (Total Charge Management System) allows for the addition of a Progressive Dynamics Charge Wizard, a powerful microprocessor that turns your Intel-Power Converter into an intelligent, completely automatic 12 Volt charging system. It constantly monitors battery voltage and then selects one of four operating modes to properly maintain and recharge the battery.



A powerful microprocessor that "automates" everything!

AC/DC Power Distribution Panels

30 AMP, 120 VAC 5000 SERIES

ATTRACTIVE, COMPETITIVELY PRICED CONTROL CENTER THAT FITS YOUR ELECTRICAL INSTALLATION COST REQUIREMENTS



Inside with full front cover off



Rear view showing screw connections

Features:

Provisions for 30 Amp AC main and up to 9 AC branch circuits.

Generous wiring space for easy installation — also reduces costly wiring errors.

Built-in wire strain relief for each branch circuit. Saves over 50% on installation costs.

Space for up to 12 fused DC branch circuits for 12 Volt lighting and DC appliance circuits.

Accepts rated fuses up to 30 Amp — eliminates auxiliary fuse panels for slide-outs and leveling jacks saving you even more money.

Attractive lightweight panel design made from black or brown impact-resistant high temperature polymers.

All 12 VDC branch circuit connections located on outside rear of panel — reducing installation time and costly errors.

High current 12 VDC input power terminal strip provides easy connection point for battery and converter.

Available Options:

(Specify options when ordering)

- 120 VAC, 15 Amp outlet available for power converters and other AC appliances.
- 11 terminal negative 12 VDC buss bar provides common connection point for all DC circuit negative wires.

Connector type and product color must be specified:

- 12 VDC screw-type circuit terminals.
- 12 VDC 1/4" tab connectors.

Measurements and Weight*:

Dimensions: 13.4"W x 7.1"H x 4.0"D

Cut-out size: 12.25"W x 5.875"H

Weight: 1.45 lbs.

*Retail and OEM Part Numbers will be determined by your selected options when you place your order.

Front control panel – access cover removed



Manufactured and Serviced
in the USA



AC/DC Power Distribution Panels

50 AMP, 240 VAC 5500 SERIES

VERSATILE! CAN BE TWO PANELS IN ONE TO SAVE COST AND SPACE

Features:

A split 50/30 panel accepts — LEFT SIDE: dual 50 Amp main and up to 10 branch circuits — RIGHT SIDE: 30 Amp main and up to 4 branch circuits.

A split 50/50 panel accepts — LEFT SIDE: dual 50 Amp main and up to 8 branch circuits — RIGHT SIDE: dual 50 Amp main and up to 4 branch circuits.

A split 30/30 panel accepts — LEFT SIDE: 30 Amp main and up to 8 branch circuits — RIGHT SIDE: 30 Amp main and up to 8 branch circuits.

Special order configurations available on request.

Compatible with 6000 Series DC Power Distribution Panel.

Press open door for easy access to circuit breakers.

AC Panel features 12 built-in push and lock strain relief connectors.

Attractive lightweight panel design made from black or brown impact-resistant high temperature polymers.

AC Panel designed with large front wiring compartment.

Available Options:

(Specify options when ordering)

- Optional 15 Amp/120 VAC outlet on rear of AC Panel

Measurements and Weight*:

Dimensions: 11.7"W x 9.2"H x 4.1"D

Cut-out size: 10.5"W x 7.5"H

Weight: 2 lbs.

*Retail and OEM Part Numbers will be determined by your selected options when you place your order.



Press open circuit breaker access door



Mount vertical or horizontal



12 Built-in strain-relief wiring connectors



Manufactured and Serviced in the USA



12 Volt DC Power Distribution Panels

6000 SERIES

DC POWER DISTRIBUTION PANEL COMPATIBLE WITH
5500 SERIES AC POWER DISTRIBUTION PANEL

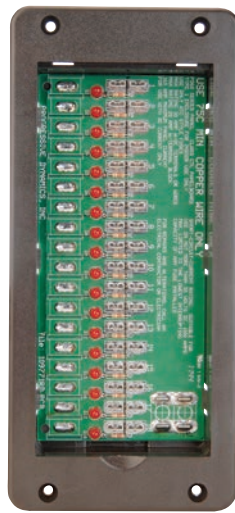
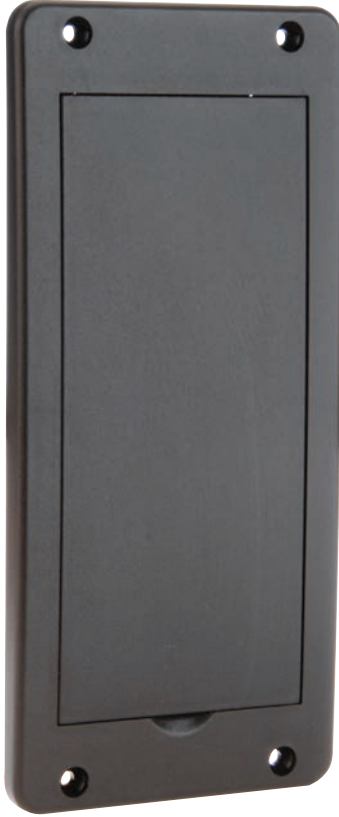

Cover open, shown with optional LED

Features:

Can be mounted vertically or horizontally.

Holds up to 18 ATC-type fuses rated for up to 30 Amps.

DC Panel has 2 built-in 12 Volt positive power terminals for connecting battery and converter positive wires.

Attractive lightweight panel design made from black or brown impact-resistant high temperature polymers.

Available Options:

(Specify options when ordering)

- 12 Volt DC output connectors available as either 1/4" tab connectors rated 30 Amps max., or screw-type rated 20 Amps max.
- Available in 12 fuse holders with 11-position ground bus bar.
- 18 fuse holder with 15-position ground bus bar.
- LED indicators alert to blown fuse.

Measurements and Weight*:

(Flush mount)

Dimensions: 4.25"W x 9.25"H x 2.0"D

Cut-out size: 3.5"W x 7.5"H

Weight: 1lb.

*Retail and OEM Part Numbers will be determined by your selected options when you place your order.



Optional 1/4" tab connectors



Manufactured and Serviced
in the USA



Automatic Transfer Switches

5100 / 5200 SERIES

SCREW TYPE WIRING TERMINALS ENSURE EASE OF WIRING AND PREVENTS WIRING ERRORS

5100 Series Automatic Transfer Switch

Features:

Quick change circuit board is easily replaced in the event of failure. No need to disconnect and reinstall the entire unit.

Time delay feature ensures generator voltage is at a stable level before transfer occurs.

Built-in strain reliefs allow the installer to simply push the branch circuit wires inside the unit for connection.

Eliminates the need to purchase and install separate strain reliefs for each circuit.

Optional screw-type wiring terminals ensure ease of wiring and prevents wiring errors.

1 year limited warranty.

U.S. Patents: RE40,354; 6,430,036.

Retail Model PD5110010V
OEM Model PD5110010

120 VAC, 30-Amps
Pig tail AC wire connections
Dimensions: 9.25"L x 7.28"W x 4.2"H
Weight: 2.5 lbs.

Retail Model PD5110610V
OEM Model PD5110610

120 VAC, 30-Amps
AC Connectors: Screw terminals
Dimensions: 9.25"L x 7.28"W x 4.2"H
Weight: 2.5 lbs.

PD5110010

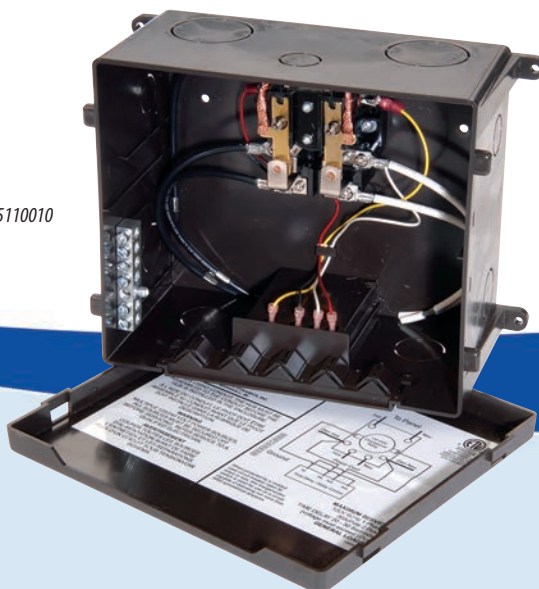

5200 Series Automatic Transfer Switch

Features:

Rugged, heavy duty, screw type wiring terminals ready to wire to contactor base. Ensure ease of wiring and prevents wiring errors.

Time delay circuit board ensures generator voltage is at a stable level before transfer occurs.

Easy to remove protective cover with wiring schematic inside.

Option for auto generator start compatibility.

70 Amp neutral rating.

1 year limited warranty.

Retail Model PD52V
OEM Model PD52

240 VAC, 50 Amps
Metal Box Dimensions: 10.38"L x 6.88"W x 4.5"H
Weight: 7 lbs.

NEW! Retail Model PD52DCSV
NEW! OEM Model PD52DCS

Silent Surge Protection – see www.progressivedyn.com for product specifications

Surge protected, 240 VAC, 50 Amps
Metal Box Dimensions: 10.25"L x 8.25"W x 5.5"H
Weight: 9.8 lbs.

PD52V

PD52DCSV



Manufactured and Serviced
in the USA



SPECIALTY PRODUCTS

SPECIALTY PRODUCTS FROM PROGRESSIVE DYNAMICS, INC. ARE SUITED FOR VARIOUS SPECIALTY VEHICLES AND OTHER APPLICATIONS FOR A RANGE OF INDUSTRIES.



Specialty Vehicle & Other Applications

5300 SERIES

CONTACTOR DESIGNED
AUTOMATIC TRANSFER SWITCH

Provides automatic power source switching between two separate 120/240 VAC input sources. A typical application is to switch between a shoreline connected cord and an onboard generator. The transfer switch senses the presence of the available supplies and automatically selects the proper one.

Standard features:

- Electrical and mechanical interlocks prevent cross connection of power sources.
- Quick change circuit board is easily replaced in the event of failure. No need to disconnect and reinstall the entire unit.
- Time delay ensures generator voltage is at a stable level before transfer occurs. The time delay can be disabled when an inverter is used as the alternate source.
- Rugged, heavy duty, screw type wiring terminals allow direct connection to contactor for more reliable operation.
- Heavy duty metal enclosure with easy to use wiring diagram permanently attached.
- 1 year limited warranty.



Specifications*:

PD53-100
Voltage: 120/240 VAC
Amperage: 100 Amps
Dimensions: 12"L x 10"W x 6"H
Weight: 17 lbs.

*Not agency listed.



24 VOLT

25 & 40 AMP POWER CONVERTER/
BATTERY CHARGER

Inteli-Power 9200® Series Power Converter/Battery Charger for Specialty Vehicles and Other Applications with Built-in, 4-Stage Charging for Better Battery Management

Provides 24 Volt output in either a 25 Amp or 40 Amp configuration. Typical applications include battery charging for shuttle buses, local refrigeration delivery trucks, display vans, emergency vehicles, communication trucks, over-the-road trucks with sleeper cabs, and solar energy.

Standard features:

- Built-in Charge Wizard®, 4-stage charging system constantly monitors batteries and automatically adjusts your converter output voltage based on the battery's charge status.
- Made in America for better quality, service and support.
- Reverse battery protection protects converter from damage resulting from improper (reverse) battery lead connection.
- Electronic current limiting automatically reduces output voltage when maximum capacity is reached.
- 2 year limited warranty.



Specifications:

PD9240-24A*
Input: 105-130 VAC, 50/60 Hz,
1300 Watts
Output: 27.2 VDC, 40 Amp
Dimensions:
11.65"L x 7.38"W x 3.6"H
Weight: 7.5 lbs

PD9225-24
Input: 105-130 VAC, 50/60 Hz,
900 Watts
Output: 27.2 VDC, 25 Amp
Dimensions:
8.25"L x 7.25"W x 4.7"H
Weight: 4.5 lbs.



*Plugs into a 20 Amp outlet. Removal or alteration of converter 20 Amp power cord will void warranty.



Manufactured and Serviced
in the USA

12 & 24 Volt Converter/Chargers for Lithium Batteries

INTELI-POWER® 9100L SERIES

DESIGNED TO MEET STRINGENT VOLTAGES REQUIRED FOR PROPERLY CHARGING & MAINTAINING LITHIUM ION BATTERIES

Engineered for Power-Hungry Applications

25, 30, 40, 45, 60, 70 & 80 Amp Models Available

Standard features on all models:

- Reverse battery protection protects converters from damage resulting from improper (reverse) battery lead connection.
- Units deliver filtered DC power to the Lithium Ion Batteries to ensure their built-in electronic balancing circuits operate properly.
- Electronic current limiting automatically reduces output voltage when maximum capacity is exceeded. Protects your investment.
- Low line voltage protection automatically shuts converter down if input voltage is insufficient.
- Variable speed intelligent cooling fan automatically monitors converter temperature and activates fan at speed required.
- High voltage protection protects converter from spikes or surge of voltage over 135V.
- Automatic thermal protection reduces converter output to safe levels when unit temperature exceeds pre-set limits and protects converter from damage due to excessive heat.
- Output Voltage can be FACTORY ADJUSTED to meet OEM requirements for various Lithium Ion Battery chemistries and voltages. Standard "L" series voltages are set for 14.6/28.55 volts to meet requirements for Lithium Iron Phosphate Batteries. Other chemistries may require different voltages.
- The PD9100L Series can be wired in parallel to charge at much higher current rates. They can also be wired in series/parallel to charge 36, 48, 60, 72 and higher voltage battery packs at high charge rates.
- 2 year limited warranty.

What are the advantages of Lithium Ion Batteries?

Stores 3-4 times the energy of a lead/acid battery in the same space, with less weight.

Nearly constant output voltage during discharge. Delivers full power longer to all systems improving performance.

Operates over a wide range of temperatures. -4F to +158F.

Can charge and discharge thousands of times vs. 300-400 cycles for lead/acid batteries.

Retains 80% of charge for 12 months, vs. lead/acid batteries, which discharge to 80% of capacity in only 30 days!

Lithium Ion Batteries do not require maintenance. No more adding water. No more venting of explosive gasses!

Lithium Ion Batteries are the future, providing excellent performance in golf carts, electric vehicles, solar power storage, forklifts and many other applications.

Lithium Ion Batteries require special balancing circuits and chargers!

12-Volt Lithium Ion Batteries are composed of 4 cells, each with a voltage rating of 3.2-volts wired in series providing a total output of 12.8 Volts. Lithium Iron Phosphate type cells are the safest and most common type used, however, they must never be charged to a voltage over 4-Volts and must never be discharged below 2-volts, or they will be damaged. *Note: Other cell chemistries require different voltage limits.*

Due to manufacturing inconsistencies, each Lithium Ion Cell is different (i.e. they will each charge and discharge at different rates). These cell differences make recharging Lithium Batteries fairly complex and requires that the battery manufacturer install electronic balancing circuits inside the battery to prevent overcharging a cell, or discharging too much. While these balancing circuits protect the cells, they can increase recharge times, depending on the mix of cells in each 12-volt battery pack. This increase in recharge time is especially apparent in higher voltage and or higher current battery packs. Lithium Ion Batteries also require battery chargers that can produce a higher voltage than provided by standard 12-volt or 24-volt lead/acid battery chargers. Trying to recharge a Lithium Ion Battery with a standard lead/acid charger will result in a partially charged battery and **MAY REDUCE BATTERY LIFE!**



Manufactured and Serviced
in the USA



MODEL PD9180ALV

Input: 105-130 VAC 50/60 Hz.
1300 Watts
Output: 14.6 Volts VDC 80-Amps
Dimensions: 11.65"L x 7.38"W x 3.6"H
Weight: 7.5 lbs.

**80
AMP**



Plugs into a 20 Amp outlet. Removal or alteration of converter 20 Amp power cord will void warranty.

Model PD9160ALV

Input: 105-130 VAC 50/60 Hz.
1000 Watts
Output: 14.6 Volts VDC 60-Amps
Dimensions: 9.15"L x 7.38"W x 3.6"H
Weight: 5.8 lbs.

**60
AMP**



Model PD9145ALV

Input: 105-130 VAC 50/60 Hz.
725 Watts
Output: 14.6 Volts VDC 45-Amps
Dimensions: 8.25"L x 7.25"W x 4.7"H
Weight: 4.5 lbs.

**45
AMP**



Model PD9130LV

Input: 105-130 VAC 50/60 Hz.
500 Watts
Output: 14.6 Volts VDC 30-Amps
Dimensions: 8.25"L x 7.25"W x 4.7"H
Weight: 4 lbs.

**30
AMP**



Model PD9140-24ALV

Input: 105-130 VAC 50/60 Hz.
1,300 Watts
Output: 28.55 Volts VDC 40-Amps
Dimensions: 11.65"L x 7.38"W x 3.6"H
Weight: 7.5 lbs.

**40
AMP**



Plugs into a 20 Amp outlet. Removal or alteration of converter 20 Amp power cord will void warranty.

Model PD9125-24LV

Input: 105-130 VAC 50/60 Hz.
900 Watts
Output: 28.55 Volts VDC 25-Amps
Dimensions: 8.25"L x 7.25"W x 4.7"H
Weight: 4.5 lbs.

**25
AMP**



All-In-One Converter/Chargers for Lithium Batteries

INTELI-POWER® WALL MOUNT SERIES

**FAST CHARGING TIMES — UP TO 99% IN 2.5 HOURS
VERSUS UP TO 13 HOURS FOR LEAD-ACID BATTERIES**

Model PD4560LIK18LS8

Input: 105-130 VAC 50/60 Hz.
1000 Watts
Output: 14.6VDC 60-Amps
Dimensions:
11.85"W x 14.125"H x 7.80"D
Cutout Size: 10.125"W x 13.25"H
Weight: 8 lbs.

**60
AMP**



Model PD4045LIKA

Input: 105-130 VAC 50/60 Hz.
725 Watts
Output: 14.6VDC 60-Amps
Dimensions:
11.85"W x 14.125"H x 7.80"D
Cutout Size: 10.125"W x 13.25"H
Weight: 8 lbs.

**45
AMP**



Model PD4060LIK

Input: 105-130 VAC 50/60 Hz.
1000 Watts
Output: 14.6VDC 60-Amps
Dimensions: 12.28"W x 8.875"H x 7.25"D
Cutout Size: 10.75"W x 7.25"H
Weight: 6.7 lbs.

**60
AMP**



Progressive Dynamics RV Converter Crossover List

| Progressive Dynamics Part Number | Replaces |
|---|--|
| Deck Mount | |
| PD9130V | Parallax 7430 lota DLS-30 |
| PD9140AV | WFCO WF-9835 (w/PD9105V Charge Wizard added) Parallax 7440 Parallax 4435 (w/PD9105V Charge Wizard added) |
| PD9145AV | WFCO WF-9845 (w/PD9105V Charge Wizard added) Parallax 7445 lota DLS-45 Powermax PM4-45 (w/PD9105V Charge Wizard added) Powermax PM3-45 (w/PD9105V Charge Wizard added) |
| PD9245-CV | WFCO WF-9845 Parallax 7445 Parallax 4445 lota DLS-45 Powermax PM4-45 Powermax PM3-45 |
| PD9160AV | WFCO WF-9855 (w/PD9105V Charge Wizard added) Parallax 7455 lota DLS-55 Powermax PM4-55 (w/PD9105V Charge Wizard added) Powermax PM3-55 (w/PD9105V Charge Wizard added) |
| PD9260-CV | WFCO WF-9855 Parallax 7455 Parallax 4455 lota DLS-55 Powermax PM4-55 Powermax PM3-55 |
| PD9270 | WFCO WF-9865 Parallax 7465 |
| PD9180AV (*20 AMP PLUG) *This unit does not have Power Factor Correction | WFCO WF-9875 (w/PD9105V Charge Wizard added) lota DLS-75 |
| PD9280AV (*20 AMP PLUG) *This unit does not have Power Factor Correction | WFCO WF-9875 lota DLS-75 Powermax PM3-75 Powermax PM4-75 |

| Progressive Dynamics Part Number | Replaces | |
|------------------------------------|---|---|
| Wall Mount - 30 Amp Service | | |
| PD4045KV | WFCO WF-8945ANP WFCO WF-8740P Parallax 7345 Parallax 8345 Parallax 7145 Powermax PPC-32 Powermax PPC-45 | |
| | PD4060KV | WFCO WF-8955PEC Parallax 7355 Parallax 8355 Parallax 7155 Powermax PPC-55 |
| | PD4135KW2 | WFCO WF-8735 |
| | Wall Mount - 50 Amp Service | |
| | PD4560K18LS8V | WFCO WF-9960 Parallax 555 Parallax 5355 |
| | PD4575K18LS8V | Parallax 5365 Parallax 53753 |
| PD4590K18LS8V | WFCO WF-9990 | |
| Replacement Sections | | |
| PD4635V | WFCO WF-8935MBA | |
| PD4645V | WFCO WF-8945REP WFCO WF-8945MBA Parallax 7345R Parallax 8345R Parallax 6345R Powermax PM3-45-MBA | |
| | PD4655V | WFCO WF-8955REP WFCO WF-8955MBA Parallax 7355R Parallax 8355R Powermax PM3-55-MBA |

Not all units are a direct replacement. Modifications may be required.

Please contact our service department with any questions at 269-781-4242.



Manufactured and Serviced
in the USA

RV Ceiling Lights

REPLACEMENT LENSES

Lens Styles – OEM replacement lenses fit all 750/760 Series lights



810590
White
80 bulk/carton
Lens Style "W"



810527
Optic
80 bulk/carton
Lens Style "O"



807673
Prismatic
80 bulk/carton
Lens Style "C"



PD305
White Lens
2/Bag, 50/Cartron



PD306
Prismatic Lens
2/Bag,
50/Cartron



PD304
Optic Lens
2/Bag, 50/Cartron

Lens Styles – OEM replacement lenses fit all 770 Series lights



807877
White 100
bulk/carton
Lens Style
"W"



809902
Clear Optic
Skylight Style
100 bulk/
carton Lens
Style "RR"



807882
Clear Optic
Solar Style
100 bulk/
carton Lens
Style "C"



PD307
White
2/Bag,
50/Cartron



PD310
Clear Optic
Starburst
Style
2/Bag,
50/Cartron



PD309
Clear Optic
Skylight
Style
2/Bag,
50/Cartron



PD308
Clear Optic
Solar Style
2/Bag,
50/Cartron

Lens Styles for 780 Series lights



PD311
Optic Lens
2/Bag,
50/Cartron



PD312
White Lens
2/Bag,
50/Cartron

Lens Styles – OEM replacement lenses fit all 790 Series lights



810867
Double white
lens –
50 bulk/
carton
Lens Style "W"



810868
Single white
lens –
100 bulk/
carton
Lens Style "W"

Retail Replacement Lenses:

PD316 Double, White,
1/Bag, 50/Cartron

PD315 Single, White,
2/Bag, 50/Cartron

Marine Electronic Converter/Chargers

INTELI-POWER® 2100 SERIES

PD2100 SERIES ELECTRONIC MARINE CONVERTER/CHARGERS WITH FOUR-STAGE CHARGING SYSTEM



Standard features on all models:

- Four-Stage Charging System – Microprocessor constantly monitors battery voltage and automatically selects one of the four charging modes: BOOST, NORMAL, STORAGE or EQUALIZE.
- 3 Diode Isolated Outputs – Allows the Converter/Charger to charge three separate banks of batteries. Each output is capable of handling the full rated current of the charger.
- Reverse Battery Protection – Prevents Converter/Charger from being damaged if the batteries are accidentally connected to the charger in reverse.
- Over and Under Voltage Protection – Prevents high voltage spikes and brownouts from damaging the Converter/Charger.
- Electronic Current Limiting – Limits the output current to the maximum rating of the charger to prevent over heating and damage caused by shorts or excessive loads.
- Variable Speed Intelligent Cooling Fan – Only runs as fast as required to maintain a more constant operating temperature inside the Converter/Charger. This feature reduces thermal stress caused by fans that cycle on and off.
- Programmable in the Field – PD2100 Series Intel-Power Converter/Chargers are programmable in the field to provide optimum charging profiles for lead-acid, gel-cell or AGM batteries. See illustration on next page.
- Automatic thermal protection – reduces converter output to safe levels when unit temperature exceeds pre-set limits and protects converter from damage due to excessive heat.
- Series or Parallel Connection – Intel-Power Converter/Chargers can be connected in series to provide a combination 12/24 Volt system or in parallel to provide more current.



Converter/Charger Operating Status Digital Display Screen

Meter displays output voltage for all three outputs.
With power off, it displays actual battery voltages.



Digital Meter Displays: Current, Voltage, Operation Mode, Blown Fuse Indication, and Battery Type.

In-the-field programming the PD2100 Series for battery type is easy. Program ensures proper charge profile for lead-acid, gel-cell, or AGM batteries. Also has built-in self-test.

CHANGE BATTERY TYPE AS FOLLOWS:

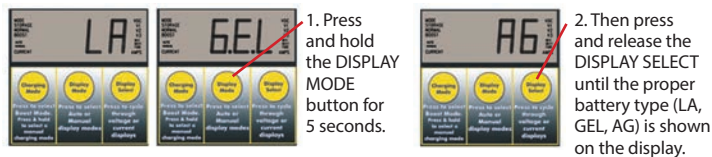

Microprocessor-controlled four stage charging system provides rapid recharge and long battery life.

The Intelli-Power Four-Stage Charging System – Provides optimum charging voltage at all times during the recharge cycle. Battery voltage is constantly monitored by the microprocessor, which automatically selects one of four operating modes:

BOOST MODE – Selected whenever the battery voltage is very low. Boost Mode provides a higher charging voltage to rapidly bring the battery up to 90% of full charge. The digital display will read BOOST when the charger is in this mode.

NORMAL MODE – Automatically selected once the battery reaches the 90% charged level. This lower voltage safely completes the charge and remains in this mode as long as the 12 Volt systems in the boat are being operated. The digital display will read NORMAL in this mode.

STORAGE MODE – Activated automatically when the 12 Volt systems are turned off and the battery has been fully charged for a period of 30 hours. The digital display will read STORAGE when in this mode.

***Exclusive! Equalize Mode** – Helps prevent battery stratification and power-robbing sulfation. When in the Storage Mode, the microprocessor automatically equalizes the battery by increasing the voltage from 13.2 Volts to 14.4 Volts for approximately 15 minutes every 21 hours. This remixes the electrolyte mixture of water and sulfuric acid. Battery manufacturers recommend that Lead-Acid batteries be equalized every 30 days or 10 discharge cycles.

What is battery stratification? The electrolyte in lead-acid batteries is water and sulfuric acid. If a battery is not fully charged immediately after discharge, the sulfuric acid begins to form a layer of heavy concentration at the lower portion of the battery. Our exclusive Equalize Mode helps prevent stratification and sulfation.

*NOTE: Gel-Cell and AGM batteries do not require an Equalize Mode.

80, 60, 50, 40, 30 & 20 Amp Models Available

80 AMP | OEM/Retail PD2180V
Input: 105-130 VAC, 50/60 HZ, 1300 Watts
Dimensions: 15.2"L x 7.8"W x 4.2"H
Weight: 9.2 lbs.

50 AMP | OEM/Retail PD2150V
Input: 105-130 VAC, 50/60 HZ, 900 Watts
Dimensions: 10.9"L x 7.8"W x 4.2"H
Weight: 6.3 lbs.

30 AMP | OEM/Retail PD2130V
Input: 105-130 VAC, 50/60 HZ, 550 Watts
Dimensions: 10.9"L x 7.8"W x 4.2"H
Weight: 5.8 lbs.

60 AMP | OEM/Retail PD2160V
Input: 105-130 VAC, 50/60 HZ, 1000 Watts
Dimensions: 10.9"L x 7.8"W x 4.2"H
Weight: 6.4 lbs.

40 AMP | OEM/Retail PD2140V
Input: 105-130 VAC, 50/60 HZ, 650 Watts
Dimensions: 10.9"L x 7.8"W x 4.2"H
Weight: 5.9 lbs.

20 AMP | OEM/Retail PD2120V
Input: 105-130 VAC, 50/60 HZ, 350 Watts
Dimensions: 10.9"L x 7.8"W x 4.2"H
Weight: 5.7 lbs.



Manufactured and Serviced
in the USA





Progressive Dynamics, Inc.

The Source of Bright Ideas Since 1964

507 Industrial Rd., Marshall, MI 49068

269-781-4241 • Fax: 269-781-7802

sales@progressivedyn.com

www.progressivedyn.com



© 2018 Progressive Dynamics, Inc. All rights reserved.
Inteli-Power, Total Charge Management System, TCMS,
Charge Wizard and Converter Control Center are
registered trademarks of Progressive Dynamics, Inc.
48-8835 711141J

