



INSTRUCTIONS FOR HENDRICKSON SUSPENSION MODEL 05411HCA9 ONSPOT CHAINS

1. Install the supplied U-bolts by sliding them over the beam housing approximately 19 inches behind centerline of front drive axle. (See Fig 1)

(It is suggested to install units on the rear side of the front drive axle due to less interference with driveline and universal components.)
2. Attach the ONSPOT chain unit to the suspension beam U-bolt with U-bolt nuts. The chain unit will mount flush with the bottom of the suspension beam. (Fig 3)
(DO NOT tighten U-bolt nuts at this time. Adjustments will need made to insure chainwheel will hit tire centerline.)
3. Attach chainwheel to unit: (RED - Driver Side)
(BLUE- Pass. Side)
4. Activate chain unit with shop air & ball valve. Position unit on beam until chainwheel contacts the tire centerline. Tighten U-bolt nuts at this time. (Torque to 177 ft. lbs.)
5. Adjust chainwheel for the correct PITCH and OPERATING ANGLE. (See Fig 1 and Fig 2) Refer to *Adjustable Chainwheel Instructions*

Hardware Includes:

- 2 – #586011RT28 (5/8" x 6" x 11" Round Top U-bolts w/nuts & washers)

Installations diagrams for Hendrickson Fabricated Beams

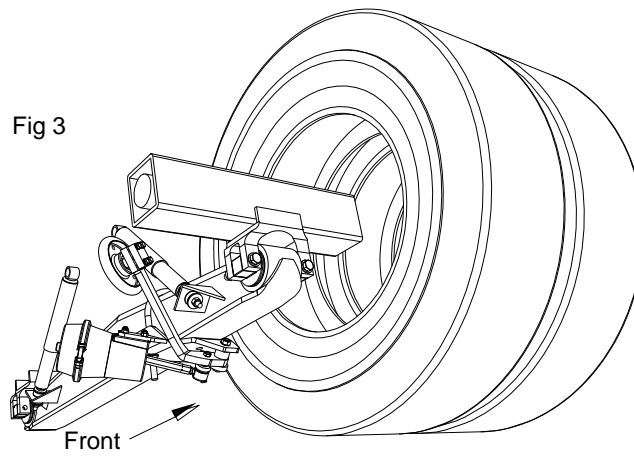
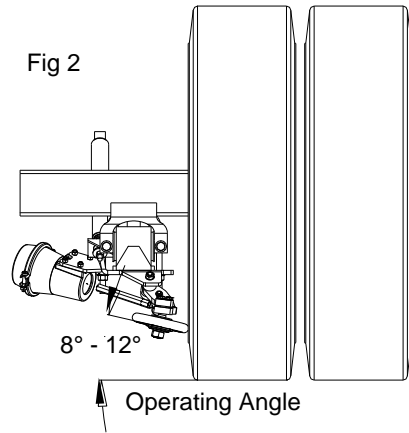
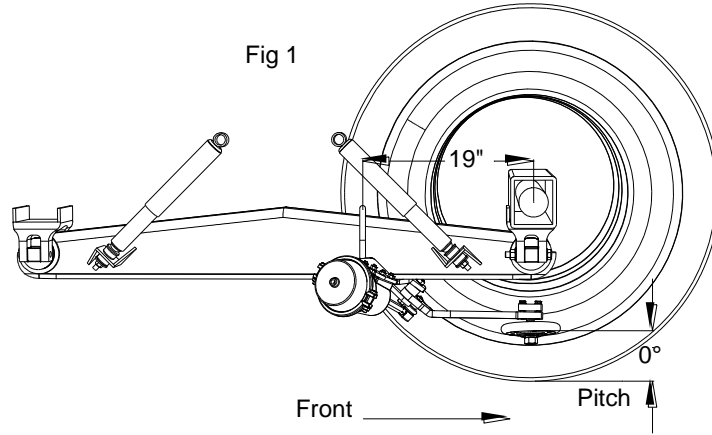

ADJUSTABLE WHEEL INSTRUCTIONS

Once the chain set is mounted, the wheel should be installed on the adjustable chainwheel bolt and brought into contact with the tire sidewall. In this position, establish the proper operating angle of, 8 to 12 degrees, at a height between 3 1/2 and 4 inches above the ground. The operating angle and the pitch can be set simultaneously. Refer to the chain mounting instructions.

Beginning with Serial Number 65942 an addition of a set screw in the retainer requires the following instruction changes. Tighten the four (4) capscrews to the desired torque setting, approximately 35 ft. lbs, thereby locking the wheel into the desired, fixed, position. Each capscrew should be tightened a little at a time, in a circular motion until the required torque is reached. Avoid bending the retainer or arm by over tightening. Once the capscrew torque has been set, tighten the set screw in the top of the retainer firmly, then loosen and retighten the setscrew to set the knurled point into the ball of the adjustable chainwheel bolt. **DO NOT** tighten the set screw before setting the 35 ft lbs. torque on the four capscrews.

Be sure the wheel remains in a horizontal position at all times when viewed from the side (zero pitch, see pitch in chain mounting instructions). This will allow the chains to pass under the wheel, maximize the bite affect and minimize unnecessary wear on the chain wheel due to scuffing.

Place the chainwheel spacer between the helmet and chainwheel **if** lowering the tire sidewall contact height is desired. Placing the chainwheel spacer under the chainwheel, when lowering the contact height is not necessary, keeps the threaded end of the chainwheel bolt covered aiding in future removal of the chainwheel. **DO NOT** place the chainwheel spacer in the top of the helmet when using the adjustable chainwheel bolt.

