

Self-contained CMOS Laser Sensor

## LR-Z Series Setting Guide

For precautions and operation details, refer to the instruction manual included with the product.

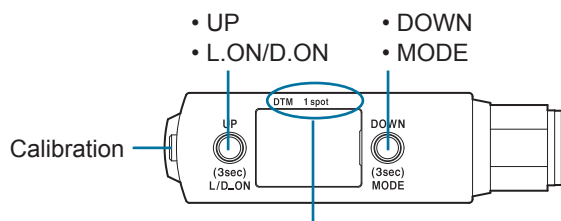
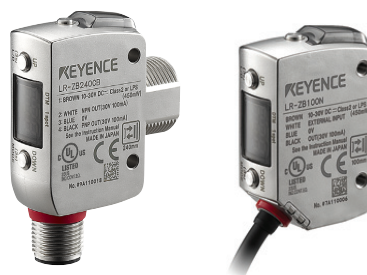

DTM: This lights up when datum calibration is performed.  
1 spot: This turns off when no light enters or multiple reflections occur.

### Calibration method

#### ● Basic setting (high accuracy) (2-point calibration, background suppression - BGS)

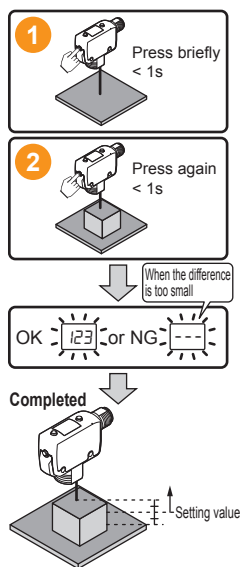

#### ● When an object other than the background is to be detected (Datum calibration, foreground suppression - FGS)

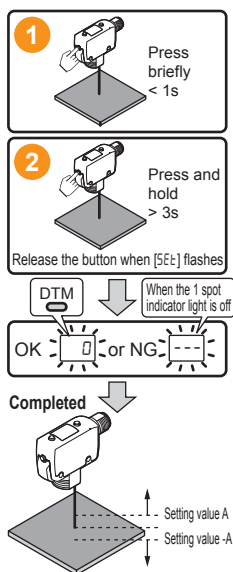

#### ● When an object located nearer than the background is to be detected (Maximum sensitivity calibration, background suppression - BGS)

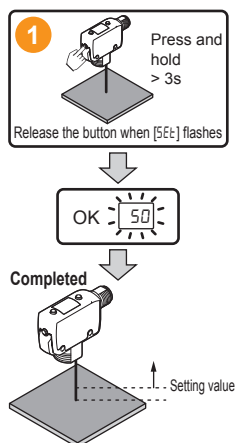

#### ● Moving target calibration (Full auto calibration, background suppression - BGS)

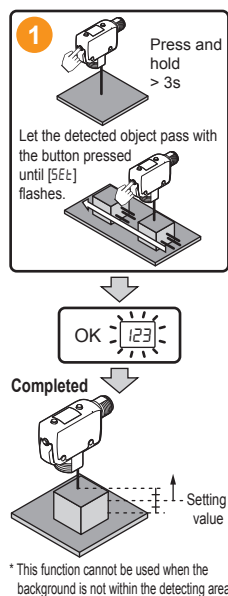

#### ● Manual adjustment

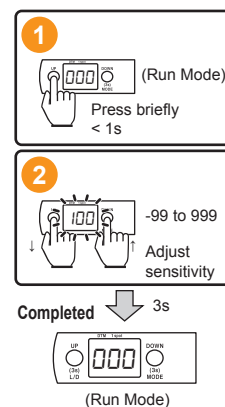

If the setting has become too complicated and you wish to start over...

### Initialization

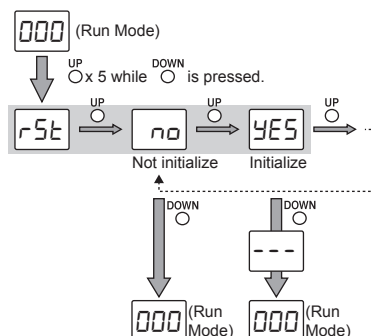

## Key lock

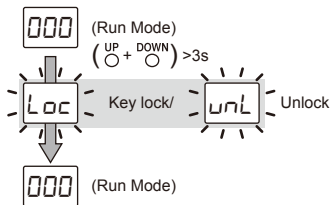

## Output configuration (L.ON ↔ D.ON)

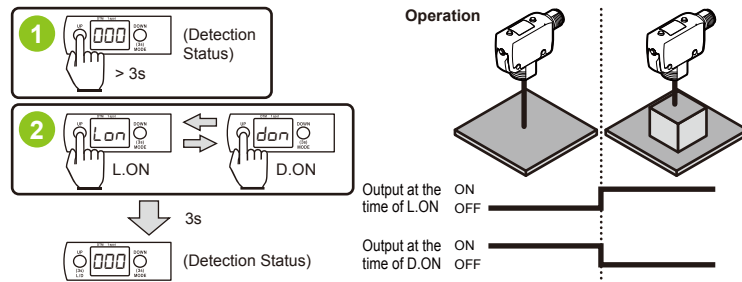

## Advanced Settings

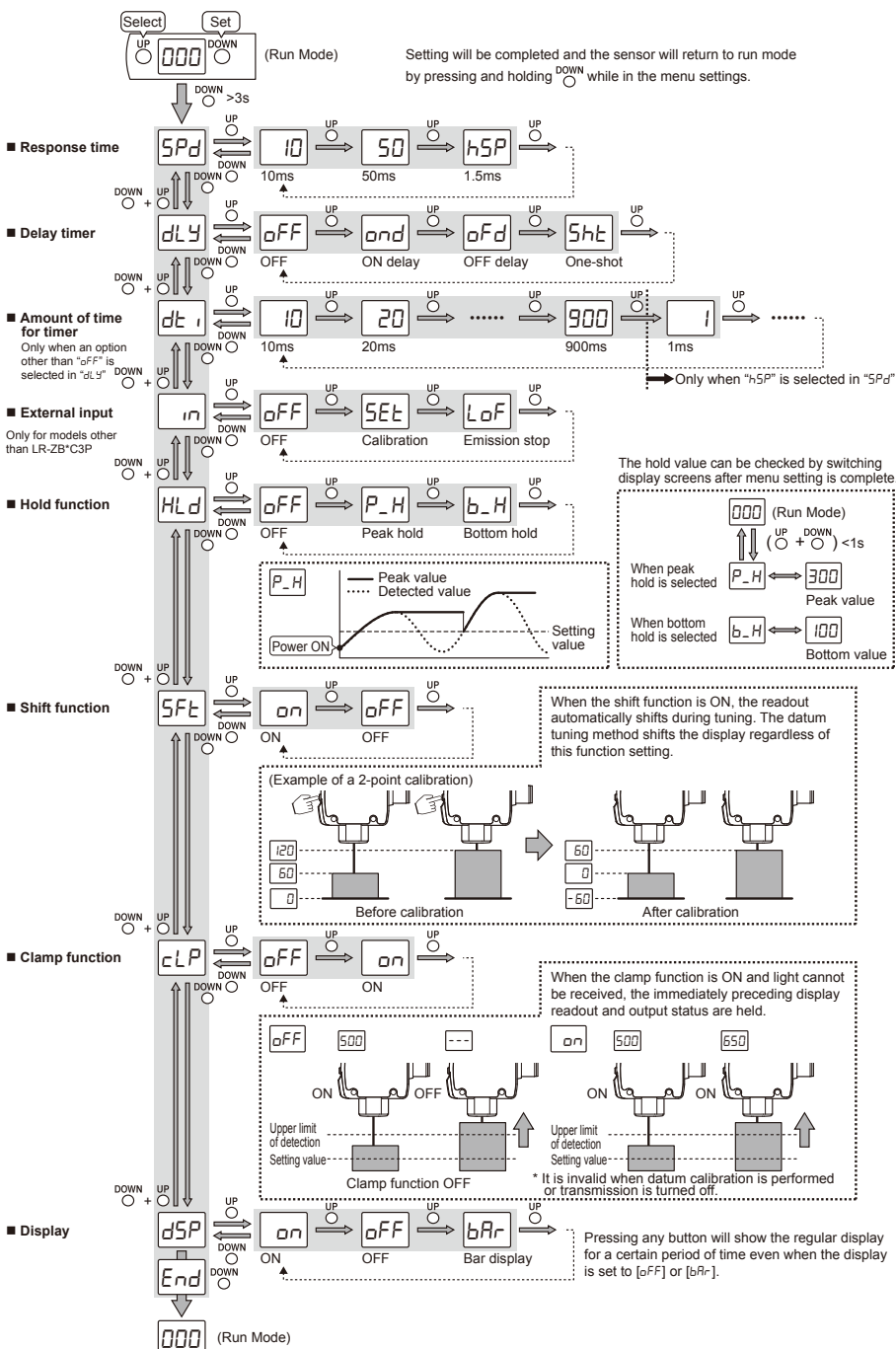

FS-N

LV-N

LR-Z

LR-T

CZ-V20

GV

GP-M

PZ-V/M

PX