

Class 1

Analog Temperature Sensor Class1 PN 108121 Quick Manual

OVERVIEW

The Analog Temperature Sensor is a compact, waterproof module that converts ambient temperature (-40°C to +125°C) to an analog voltage (174mV to 1205mV).

INSTALLATION

The Analog Temperature Sensor is simply plugged into the mating connector.

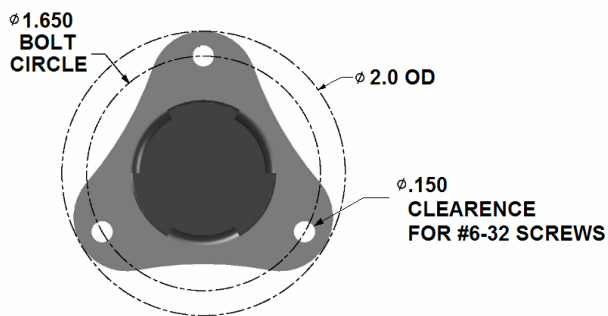

WIRING

The Analog Temperature Sensor has a single 3-pin connector.

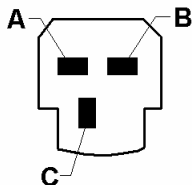

Insertion view

ATS Connector

A – Ground	INPUT	(ground)
B – Power	INPUT	(+2.7V to +10V)
C – Signal	OUTPUT	(+174mV to +1205mV)

Mating connector

3 pin Metripack (Packard)	12078090
Socket	12089290
Weather seal	12052893

SPECIFICATIONS

Accuracy	at 25°C	± 3.0°C (max)
Accuracy	for -40°C to +125°C	± 4.0°C (max)
Temperature slope		+ 6.25mV/°C
Input voltage		+2.7V to +10V
Current drain (@ 25°C)		110µA (max)
Nonlinearity		± 0.8°C (max)
Output range		+174mV to +1205mV

OUTPUT VOLTAGE DEFINITION

$$V_{out} = (T_{slope} \times T_c) + V_{offset}$$

T_{slope} = +6.25mV/°C

T_c = Temperature in Celsius

V_{offset} = +424mV

Class 1

Analog Temperature Sensor Class1 PN 108121 Quick Manual

OVERVIEW

The Analog Temperature Sensor is a compact, waterproof module that converts ambient temperature (-40°C to +125°C) to an analog voltage (174mV to 1205mV).

INSTALLATION

The Analog Temperature Sensor is simply plugged into the mating connector.

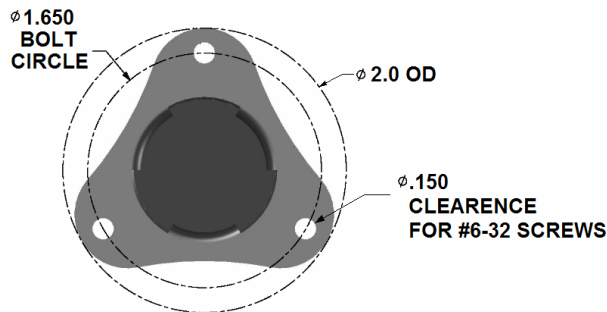

WIRING

The Analog Temperature Sensor has a single 3-pin connector.

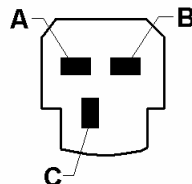

Insertion view

ATS Connector

A – Ground	INPUT	(ground)
B – Power	INPUT	(+2.7V to +10V)
C – Signal	OUTPUT	(+174mV to +1205mV)

Mating connector

3 pin Metripack (Packard)	12078090
Socket	12089290
Weather seal	12052893

SPECIFICATIONS

Accuracy	at 25°C	± 3.0°C (max)
Accuracy	for -40°C to +125°C	± 4.0°C (max)
Temperature slope		+ 6.25mV/°C
Input voltage		+2.7V to +10V
Current drain (@ 25°C)		110µA (max)
Nonlinearity		± 0.8°C (max)
Output range		+174mV to +1205mV

OUTPUT VOLTAGE DEFINITION

$$V_{out} = (T_{slope} \times T_c) + V_{offset}$$

T_{slope} = +6.25mV/°C

T_c = Temperature in Celsius

V_{offset} = +424mV