

1 2 3 4 5 6 7 8

IF IN DOUBT ASK

- NOTES:
 1. MATERIAL: 1/8" THICK 5052-H32 ALUMINUM
 2. REMOVE ALL SHARP EDGES AND BURRS
 3. * BEND LINES

PROJECTION:

COMPLIANCE NOTE:
 15 CFR 758.6 These items are controlled by the U.S. Government and authorized for export only to the country of ultimate destination for use by the ultimate consignee or end-user(s) herein identified. They may not be resold, transferred, or otherwise disposed of, to any other country or to any person other than the authorized ultimate consignee or end-user(s), either in their original form or after being incorporated into other items, without first obtaining approval from the U.S. government or as otherwise authorized by U.S. law and regulations the term "authorized" includes exports, reexports and transfers (in-country) designated under No License Required (NLR). These drawings are trademarks and copy written intellectual property of IDEX and its subsidiaries, and may not be reproduced or replicated without the express written permission of IDEX corp.

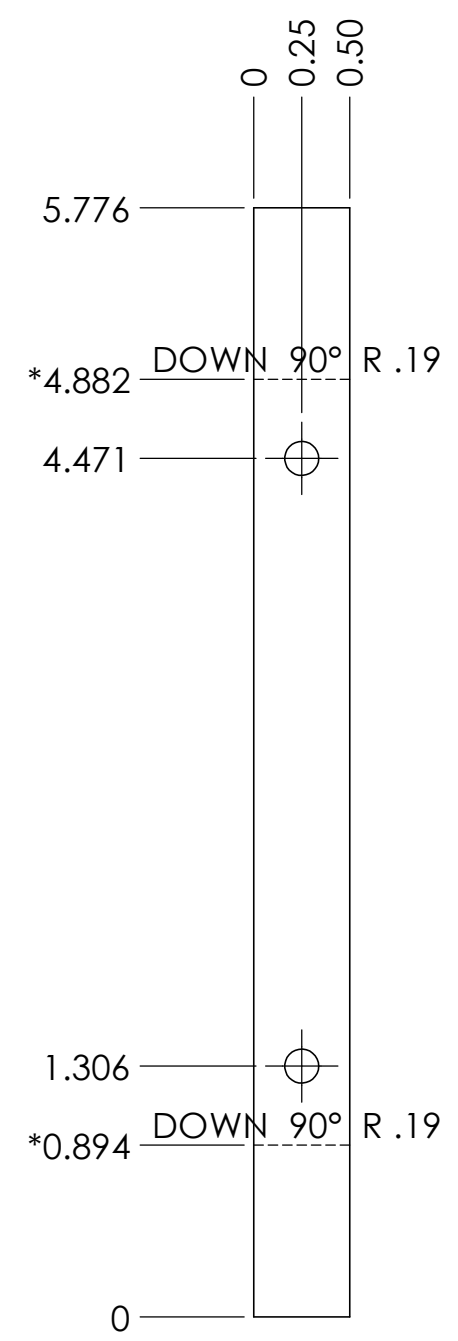
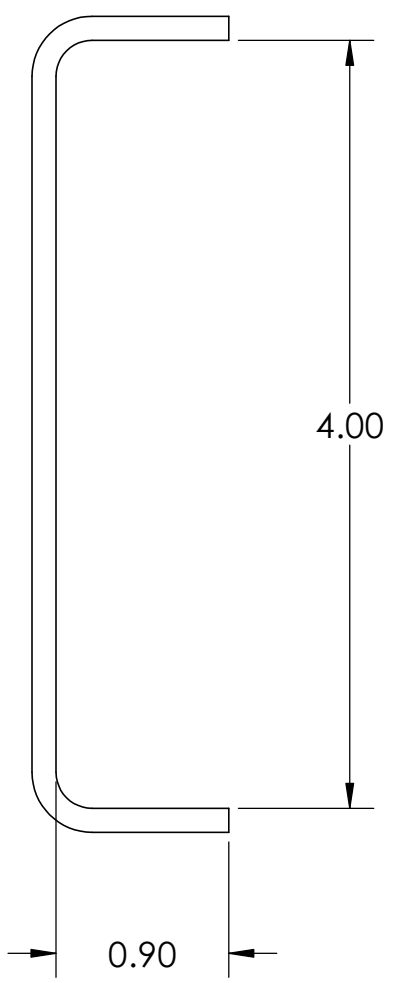
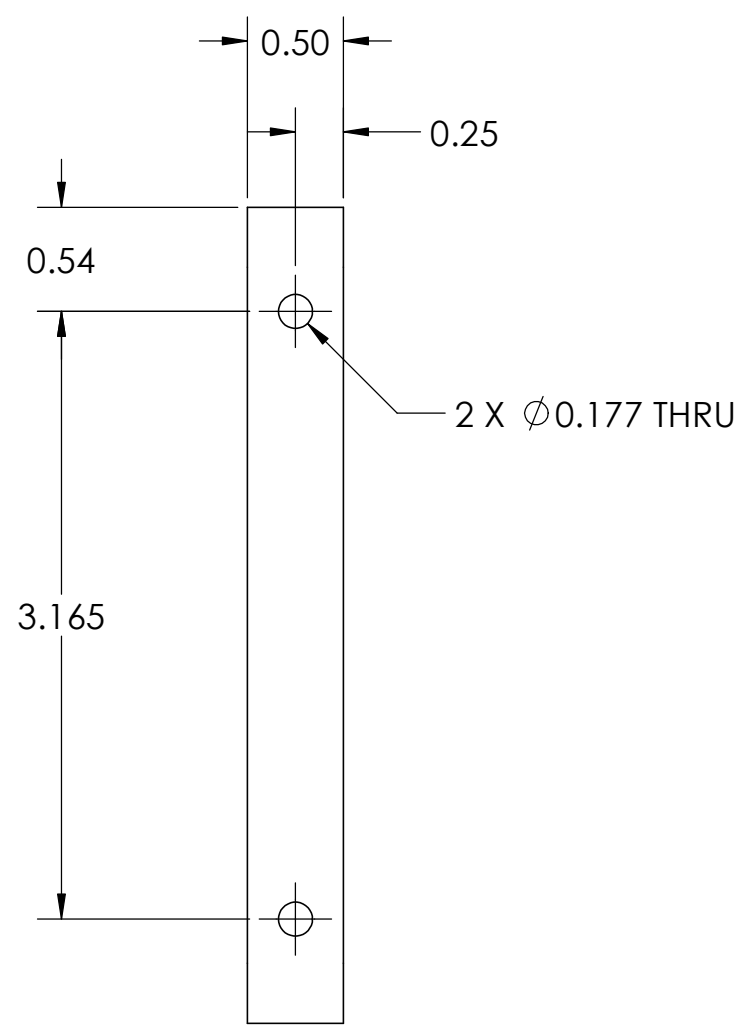

ECN	REV.	ZONE	ORIGINAL RELEASE	BMP	04MAY2020	CH
			CHANGED FROM	BY	DATE	APVD
			REVISIONS			

UNLESS OTHERWISE SPECIFIED DIMENSIONS ARE IN INCHES TOLERANCE FOR INCH DIMENSIONS: X: ±0.04 X.X: ±0.02 X.XX: ±0.01 X.XXX: ±0.005 ANGLES: ±1° SURFACE TEXTURE IN µm Ra REMOVE ALL BURRS AND SHARP EDGES, 0.01MAX		FSG OF IDEX IDEX CORPORATION	HALE GODIVA <i>Class 1</i>	
MATERIAL	MADE FROM	TITLE MOUNTING BRACKET, UV500		
FINISH	PROJECT	DRAWN BMP	APPROVED BP	
COPYRIGHT © NOT TO BE REPRODUCED OR USED TO MAKE OTHER DRAWINGS OR MACHINERY		DATE 21JUN2019	SCALE 1:1	
		DRAWING NUMBER 629-00081	REV A SHEET 1 OF 1	

1 2 3 4 5 6 7 8