

Customer Order Specification for Hale Qmid, Qmax & Qtwo Fire Pumps

Customer Name: _____ Customer P.O. NO.: _____
 Order Prepared By: _____ Hale Customer NO.: _____ Date: _____
 Fire Dept. Name: _____ City: _____ State: _____
 Requested Delivery Date: _____ Max. Elevation for Pump Test: _____ FT
 Reference Specifications: _____

Engine: Mfr: _____ Model: _____ Horsepower: _____ @ _____ RPM
 Full Load Governed RPM: _____ Peak Torque: _____ LB/FT @ _____ RPM
 Application confirmed with:(for applications not on list) _____

1. Pump Model (Circle Price of Model Desired):

FLOW (GPM)	1000	1250	1500	1750	2000	2250*
FLOW (LPM)	4000	5000	6000	7000	8000	
Pump Model	100	125	150	175	200	225
Pump Model (Metric)	400M	500M	600M	700M	800M	
SINGLE STAGE						
Qmax	\$12439	\$12439	\$12439	\$12439	\$12439	\$12439
Qmid	\$10590	\$10590	X	X	X	X
TWO STAGE						
Qtwo	\$12740	\$12740	\$12740	\$12740	\$12740	

* Rating based on (3) 6-inch suction hoses per NFPA

1A. Pump Light Kit Option (Check Applicable Box(es)):

- NFPA Midship Light Kit \$156
- No Light Kit N/C

1B. Pump Manual Option (Check Applicable Box(es)):

- Paper Manual version \$36
- CD Version (2) N/C

1C. Panel Placard Option (Check Applicable Box(es)):

- Stamped S/N Placard \$29
- No Panel Placard N/C

2. NFPA Rating (Check Applicable Box(es)):

- Provided N/C
- Dual Rating (GPM/LPM) \$175

3. Pump Body Configuration (Check Applicable Box(es)):

- Standard Machining N/C
- Special, Machining (Circle Option(s) Desired):

	OPENING				
	C	D, E, F & G	O	P	T**
3 INCH (4 BOLT)	STD	596	STD	STD	
4 INCH (8 BOLT)	309		309	309	370
6-3/8 INCH (12 BOLT)					552**
** Port "T" w/6-3/8 Inch Opening Required on 2250 GPM					
Port T is standard with 2250					

4. Drive Unit Shift and Tach Cable (Check Boxes):

A. SHIFT OPTION (airshift included as standard):

- Customer Supplied Shift Control N/C
- VPS shift Control (Not available with K Gearbox) \$ 86
- KPS shift Control (K Gearbox only) \$ 400

B. AUXILIARY OVERRIDE OPTION*

- Manual Shift Override, 72" cable \$1300
- Manual Shift Override, 55" cable \$1300
- Manual Shift Override, Turn Rod \$1300

C. TACHOMETER* (G series Only)

- No Cable or Panel Adapter N/C
- Panel Adapter Only \$ 123
- Cable and Panel Adapter \$ 230

5. Drive Unit and Pump Ratio (Circle Price of Model Desired):

MODEL	G SERIES				K Series*	
	S	L	X	R	LK	XK
3a: RATIO AND SEAL RATIO (CIRCLE ONE)						
1.58	-15	9297	9110		10248	
1.60	-16					12900 12900
1.71	-17	9297	9110		10248	12900 12900
1.86	-19	9297	9110		10248	
1.89	-19					12900 12900
1.96	-19			9374		
2.04	-21					12900 12900
2.05	-21	9297	9110		10248	
2.13	-21	9297	9110		10248	
2.28	-23	9297	9110		10248	
2.30	-23					12900 12900
2.32	-23			9374		
2.52	-25					12900 12900
2.55	-25			9374		
SEAL	PACKING		MECHANICAL		Mechanical Seal Only	Mechanical Seal Only
	N/C		490		490	490

*K Series only available on Qmax or Qtwo Pumps

6. K Gearbox Drive Line Yokes (Two required) (Check Box):

- RPL25 Spline Yoke (Price for 2) \$127
- 18T Spline Yoke (Price for 2) N/C
- 176T Spline Yoke (Price for 2) N/C
- 17T Spline Yoke (Price for 2) N/C
- 17N Full Round Yoke (Price for 2) N/C
- 176N Full Round Yoke (Price for 2) N/C
- 18N Full Round Yoke (Price for 2) N/C

7. Priming System (Circle Price of Model Desired):

PRIMER MODEL	ESP-12		ESP-24	
PRIMING VALVE	SPV	PVG	SPV	PVG
PUMP MOUNTED*		1253		1690
DRIVE UNIT MOUNTED	1741	1253	2177	1690
SHIPPED LOOSE	1741	1253	2177	1690

* Pump Mounted Primer Only Available on Qmax.

8. Relief valve (Check One Box):

- QD with PM control (Up to 1250 GPM) \$1666
- QG with PM control (Up to 1750 GPM) \$1800
- TPM with PMD control (req'd 2000 GPM) \$3600
- Dual TPM with PMD control (req'd 2250 GPM) (Rating based on (three 6 inch suction hoses per NFPA) \$4900
- No Relief Valve (1000 GPM to 2000 GPM) \$ 310
- No Relief Valve (2250 GPM) \$ 620

9. Transfer valve (Qtwo Only) (Check One Box):

- Manual (Panel width: _____ inches) N/C
- Power operated (Width: _____ inches) \$2600
- Manual (Top Mount Operator) \$2600

NOTE: Hale reserves the right to make improvements in design and materials and changes in price without notice

ALL PRICES ARE LIST IN U.S. DOLLARS F.O.B. CONSHOHOCKEN, PA 19428

Bulletin 933-2009, Sheet 1 of 4, 9 © 2009 Hale Products Inc, Printed in USA

**10. Suction Extension and Tube (One for Each Side)
(Circle Price of Items desired):**

10A: SUCTION EXTENSION		
LEFT		RIGHT
510	(178-0063-00-0)	510
624	w BOTTOM (178-0063-01-0)	624
35	OMIT	35

10B: SUCTION TUBE		
LEFT	NST x LENGTH	RIGHT
399	4-1/2 X 6	399
336	5 X 6	336
399	5 X 9	399
342	6 X 4	342
308	6 X 6	308
320	6 X 7	320
347	6 X 9	347
177	1" SPACER	177
35	OMIT	35

11. Master Intake Valve (Circle Price of Models Desired):

11A: LEFT	MIV Relief Valve	10A: RIGHT
2590	MIV-M (Side Mount)	2590
3605	MIV-E (Side Mount)	3605
130	ABV(Air Bleeder Valve)	130
140	EXTENSION HARNESS	140
3700	MIV-E (Bottom Mount Front Operator)	3700
3700	MIV-E (Bottom Mount Rear Operator)	3700
130	ABV (Air Bleeder Valve)	130
140	Extension Harness	140

11B: LEFT	MIV Relief Valve	10B: RIGHT
Standard	Stainless Steel 2-1/2" NPT	Standard
N/C	Stainless Steel 2-1/2" NST	N/C
N/C	Stainless Steel 2-1/2" VIC	N/C

NOTE: MIV Bottom mount valves require a 6 NPT, 5 Victaulic or 6 Victaulic flange to attach piping. Refer to SUCTION FLANGES Selection.

12. SUCTION FLANGES

	LEFT					RIGHT				
	U	UT	W	WT	BOTTOM	V	VT	X	XT	BOTTOM
OPEN/BLANK	12	12	12	12		12	12	12	12	
2-1/2"	60	60	60	60		60	60	60	60	
2-1/2" Angled	67	67	67	67		67	67	67	67	
3"	94	94	94	94		94	94	94	94	
3" Angled	100	100	100	100		100	100	100	100	
Magnesium Anode w/flange	170	170	170	170		170	170	170	170	
Zinc Anode w/flange	112	112	112	112		112	112	112	112	
6" NPT					305					305
5" Victaulic					195					195
5" Victaulic Angled					188					188
6" Victaulic					595					595
6" Victaulic Angled					830					830

13. DISCHARGE FLANGES

NOTE: If a flange IS NOT selected for an opening, Hale will add BLANK flanges to the order.

	STANDARD OPENINGS												SPECIAL OPENINGS							
	A	B	C	H	K	L	M	N	O	P	Q	R	C	D	E	F	G	O	P	
			3"						3"	3"			4"					4"	4"	
FLANGES (115 OR 2433 BOLT PATTERN UNLESS OTHERWISE INDICATED)																				
BLANK/OPEN	29	12	12	29	12	12	12	12	12	12	12	12	29	12	12	12	12	29	29	
1-1/4 INCH NPT (115)		60	60		60	60	60	60	60	60	60	60		60	60	60	60			
2 INCH NPT (115)		60	60		60	60	60	60	60	60	60	60		60	60	60	60			
2-1/2 INCH NPT	119	60	60	119	60	60	60	60	60	60	60	60	119	60	60	60	60	119	119	
2-1/2 INCH NPT 4° ANGLE	140	67	67	140	67	67	67	67	67	67	67	67	140	67	67	67	67	140	140	
3 INCH NPT	120	94	94	120	94	94	94	94	94	94	94	94	120	94	94	94	94	120	120	
3 INCH NPT 4° ANGLE	142	100	100	142	100	100	100	100	100	100	100	100	142	100	100	100	100	142	142	
4 INCH NPT (2433)	142			142									142					142	142	
4 INCH NPT 4° ANGLE (2433)	194			194									194					194	194	
TRV WITH 115 FLANGE		416	416		416	416	416	416	416	416	416	416		416	416	416	416			
TRV-L WITH 115 FLANGE		678	678		678	678	678	678	678	678	678	678		678	678	678	678			
MAGNESIUM ANODE W/FLANGE		170	170		170	170	170							170	170	170	170			
ZINC ANODE W/FLANGE		112	112		112	112	112							112	112	112	112			
DIRECT MOUNT FOR VALVE	N/C	N/C	N/C	N/C	N/C	N/C	N/C	N/C	N/C	N/C	N/C	N/C	N/C	N/C	N/C	N/C	N/C	N/C	N/C	

NOTE: HALE CHARGES FOR INSTALLATION AND REMOVAL OF BLANK FLANGES USED IN TESTING
Bulletin 933-2009, Sheet 2 of 4, © 2009 Hale Products Inc, Printed in USA

14 TANK SUCTION	Left S	Right T* (8-Bolt)	Right T** (12 Bolt)
OPEN (PLUG)	34	34	34
FLANGES			
BLANK	87	87	
2-½ INCH NPT	119	119	
3 INCH NPT	120	120	
3 INCH NPT 4° ANGLE	142	142	
4 INCH NPT	142	142	
4 INCH NPT 4° ANGLE	194	194	
6" NPT*			305
5" VICTAULIC**			195
5" VICATULIC ANGLED**			188
6" VICTAULIC**			595
6" VICTAULIC ANGLED**			830
CHECK VALVE ONLY	108	108	
CHECK VALVE w/PLATE (Required w/4 Inch NPT Flange)	197	197	
MIV-E**			3775
MIV ABV (AIR BLEEDER VALVE)			130
MIV EXTENSION HARNESS			140

MIV requires 6 MPT, 5 Victaulic, 5 Victaulic Angle, 6Victauli Angle Flange. Make selection above
 *4 Inch (8 Bolt) special machining required
 **6-3/8 Inch (12 Bolt) Machining Required

15. Paint Option

DESCRIPTION	PRICE
<input type="checkbox"/> Black Primer	N/C
<input type="checkbox"/> Gray Primer	\$100
<input type="checkbox"/> Hale Black Finish Coat	\$450
<input type="checkbox"/> Hale Red Finish Coat	\$450

16. Pro Tech Warranty (FIRE APPLICATIONS ONLY) (NET PRICE, NO DISCOUNTS)

<input type="checkbox"/> Standard 5 Year Warranty (Parts and Labor for the first two years, parts only years 3-5)	N/C
<input type="checkbox"/> Pro Tech Gold Warranty - 1 Additional Year of Labor	\$250
<input type="checkbox"/> Pro Tech Gold Warranty - 2 Additional Years of Labor	\$750
<input type="checkbox"/> Pro Tech Gold Warranty - 3 Additional Years of Labor	\$1500

XXX IDENTIFIES SERIES OF MATING HALE FLANGES

ALL EXTENSIONS MAY BE SUED ON LEFT OR RIGHT SIDE OF PUMPS AS NEEDED..PUMP FLANGE IS ON LEFT SIDE OF ALL ILLUSTRATIONS SHOWN

STANDARD
178-0063-00-0

1/4" NPT DRAIN CONNECTION

12 HOLES 7/16 14UNC-28 X 8.25 BC

OPTIONAL
178-0063-01-0 (CAST IRON)
178-0063-03-0 (BRONZE)

24

TRUCK PANEL WIDTH "A"

	70"	72"	74"	76"	78"	81"	
SUCTION TUBE LENGTH	DIMENSION "C"						
	4"	w/o MIV					
		w/MIV	3.63	2.63	1.63		
	6"	w/o MIV	2.25	1.25			
		w/MIV	5.63	4.63	3.63	2.63	1.63
	7"	w/o MIV	3.25	2.25	1.25		
w/MIV		6.63	5.63	4.63	3.63	2.63	
9"	w/o MIV	5.25	4.25	3.25	2.25	1.25	
	w/MIV	8.63	7.63	6.63	5.63	4.63	

FOR ADDITIONAL OR LOOSE ACCESSORIES, VALVES, FLANGES, SEE SEPARATE ACCESSORY PAGE PRICE LIST AND ATTACH TO PUMP ORDER

PUMP MODEL, CAPACITY, RATIO, DRIVE UNIT: _____

PRIMER: _____ QTWO TRANSFER VALVE: _____

SUCTION
EXTENSION: _____
MIV: _____
TUBE: _____
CAP: _____

PUMP BODY IS 48 INCHES WIDE

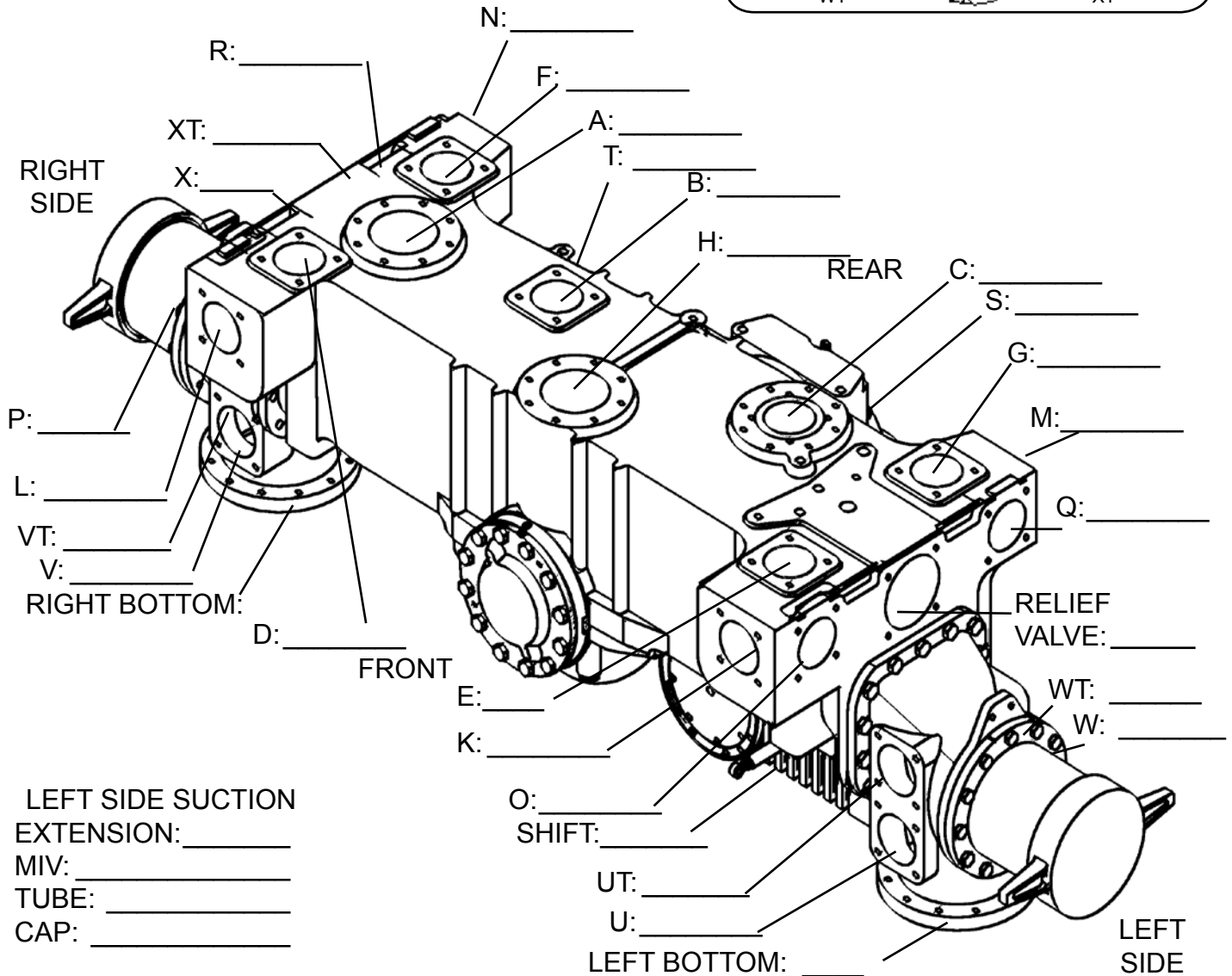
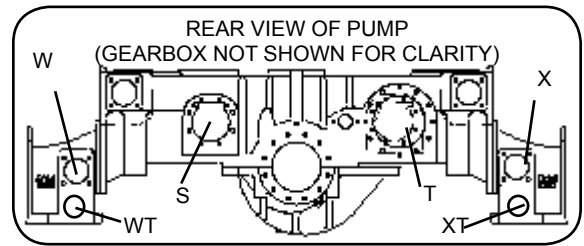

LEFT SIDE SUCTION
EXTENSION: _____
MIV: _____
TUBE: _____
CAP: _____



Hale Products, Inc. A Unit of IDEX Corp. 700 Spring Mill Avenue Conshohocken, PA 19428 USA
TEL: 610/825-6300 1-800/220-HALE FAX: 610/825-9615 www.haleproducts.com

Class 1 A Unit of IDEX Corp. 607 NW 27th Avenue Ocala FL 34475 USA
Tel: 352-629-5020 800-533-3569 Fax: 352-629-2902 www.class1.com