

CUSTOMER ORDER SPECIFICATION

Customer Name: _____ Customer P.O. NO.: _____
 Order Prepared By: _____ Hale Customer NO.: _____ Date: _____
 Fire Dept. Name: _____ City: _____ State: _____
 Requested Delivery Date: _____ Max. Elevation for Pump Test: _____ FT
 Reference Specifications: _____

Engine: Mfr: _____ Model: _____ Horsepower: _____ @ _____ RPM
 Full Load Governed RPM: _____ Peak Torque: _____ LB/FT @ _____ RPM
 Application confirmed with:(for applications not on list) _____

1. Pump Model (Circle Price of Model Desired):

P/N: 501-3451-98-0 (Schedule B Discount)

FLOW (GPM)	750	1000	1250	5000 LPM
PUMP MODEL	75	100	125	500M
QFLO PLUS	12,588	12,588	12,588	12,779

Pump configuration includes:

- Openings at D, E, F & G Machined
- Thermal Relief Valve 120L
- (3) Zinc Anodes (2 suction, 1 discharge)
- QG Relief Valve
- 3" Air Operated Tank Valve (includes tank to pump check valve)

NFPA Rating Certification Standard (Schedule B Discount)

1A. Pump Light Kit Option (Check Applicable Box(es)):

- NFPA Midship Light Kit \$184
- No Light Kit N/C

1B. Pump Manual Option (Check Applicable Box(es)):

- Paper Manual version \$36
- CD Version (2) N/C

1C. Panel Placard Option (Check Applicable Box(es)):

- Stamped S/N Placard \$29
- No Panel Placard N/C

2. Pump Body Configuration (Check Applicable Box(es)):

- Special Machining (circle choice(s)) (Schedule B Discount)

	OPENING		
	A	O	P
CAST SOLID	STD		
3" 4-BOLT		STD	STD
4" 8-BOLT	\$317	\$317	\$317

3. Drive Unit (Schedule B Discount) (Circle Price of Model Desired):

Drive Unit with Mechanical Seal		
LC	Verify Ratio with Factory	9,520
XC		10,087

Note: Certain options found in this price list are not available in Class 1 built pump modules

4. Drive Unit Shift and Tach Cable (Check Boxes): (Schedule B Discount)

A. SHIFT OPTION:

- VPS/w Control \$ 86

B. AUXILIARY OVERRIDE OPTION:

- Manual Shift Override, 72" cable \$1300
- Manual Shift Override, 55" cable \$1300
- Manual Shift Override, Turn Rod \$1300

C. TACHOMETER

- No Cable or Panel Adapter N/C
- Panel Adapter Only \$ 123
- Cable and Panel Adapter \$ 230

5. Priming System (Circle Model Desired): (Schedule B Discount)

PRIMER MODEL	ESP-12
PRIMING VALVE	PVG
SHIPPED LOOSE	1,293

6. Suction Extension and Tube (One for Each Side) (Circle Price of Items desired): (Schedule B Discount)

6A SUCTION EXTENSION		
LEFT		RIGHT
523	(178-0063-00-0)	523
641	w BOTTOM (178-0063-01-0)	641
35	OMIT	35

6B: SUCTION TUBE		
LEFT	NST x LENGTH	RIGHT
399	4-1/2 X 6	399
336	5 X 6	336
399	5 X 9	399
344	6 X 4	344
310	6 X 6	310
321	6 X 7	321
347	6 X 9	347
178	1" SPACER	178
35	OMIT	35
1704	FILL THIEF**	1704

* required with MIV

**NOTE: Fill Thief fitting is exposed and requires a notched pump panel.

**NOTE: Fill Thief requires a MIV

NOTE: Hale reserves the right to make improvements in design and materials and changes in price without notice

ALL PRICES ARE U.S. DOLLARS F.O.B. CONSHOHOCKEN, PA 19428 USA

Sheet 1 of 8, © 2009, Hale Products Inc, Printed in USA

NOTE: CERTAIN OPTIONS FOUND IN THIS PRICE LIST ARE NOT AVAILABLE IN CLASS 1 BUILT PUMP MODULES

7. Master Intake Valve (Circle Price of Models desired) (Schedule B Discount)

7A: LEFT	MIV Relief Valve	7A: RIGHT
2590	MIV-M (Side Mount)	2590
3674	MIV-E (Side Mount)	3674
130	ABV(Air Bleeder Valve)	130
140	EXTENSION HARNESS	140
3700	MIV-E (Bottom Mount Front Operator)	3700
3700	MIV-E (Bottom Mount Rear Operator)	3700
136	ABV (Air Bleeder Valve)	136
140	Extension Harness	140

7B: LEFT	MIV Relief Valve	7B: RIGHT
Standard	Stainless Steel 2-1/2" NPT	Standard
N/C	Stainless Steel 2-1/2" NST	N/C
N/C	Stainless Steel 2-1/2" VIC	N/C

NOTE: MIV Bottom mount valves require a 6 Inch NPT or 5 or 6 Inch Victaulic connection to attach piping. Refer to SUCTION FLANGES Selection.

8. TANK SUCTION (Schedule B Discount)

Required CAFSPro Opening S: 3" SVS with 3" NPT/4" Victaulic Connector, 8-bolt 3.5° Pump Mount Adapter (741-4006-06-0), Corrosion Resistant check Valve. Schedule B discount

- 3" (831-2406-18-0) **N/C**
- 4" (841-4048-06-0) \$ 972 (NOTE: This is the upcharge to go from a 3" to a 4" valve)

9. TPM RELIEF VALVE (Schedule B Discount)

- TPM Relief Valve \$1,938

10. SUCTION FLANGES (Schedule B Discount)

	LEFT			RIGHT			
	U	UT	BOTTOM	V	VT	XT	BOTTOM
OPEN/BLANK	12			12		12	
2-1/2	60			60		60	
2-1/2 Angled	67			67		67	
3	94			94		94	
3" Angled	100			100		100	
Magnesium Anode w/flange	176			176		176	
Zinc Anode w/flange	115	STD		115	STD	115	
6 NPT			305				305
5 Victaulic			195				195
5 Victaulic Angled			188				188
6 Victaulic			595				595
6 Victaulic Angled			830				830

7. Pro Tech Warranty (PUMP ONLY) (NET PRICE, NO DISCOUNTS)

- Standard 5 Year Warranty (Parts and Labor for the first two years, parts only years 3-5) **N/C**
- Pro Tech Extended Warranty - 1 Additional Year of Labor \$250
- Pro Tech Extended Warranty - 2 Additional Years of Labor \$750
- Pro Tech Extended Warranty - 3 Additional Years of Labor \$1500

FOR ADDITIONAL OR LOOSE ACCESSORIES, VALVES, FLANGES, SEE SEPARATE ACCESSORY PAGE PRICE LIST AND ATTACH TO PUMP ORDER

Please see the Class 1 Price List for prices on Caps

12. DISCHARGE FLANGES (Schedule B Discount)

NOTE: If a flange IS NOT selected for an opening, Hale will add **BLANK** flanges to the order.

	B	C	D	E	F	G	H	O 3"	M	N	P 3"	Q	R	SPECIAL OPENINGS		
														A	O 4"	P 4"
FLANGES (115 OR 2433 BOLT PATTERN UNLESS OTHERWISE INDICATED)																
BLANK/OPEN	12			12	12	12	29	12	12	12	12	12	12	29	29	29
1-¼ INCH NPT (115)	60			60	60	60		60	60	60	60	60	60			
2 INCH NPT (115)	60			60	60	60		60	60	60	60	60	60			
2-½ INCH NPT	60			60	60	60	119	60	60	60	60	60	60	119	119	119
2-½ INCH NPT 4° ANGLE	67			67	67	67	140	67	67	67	67	67	67	140	140	140
3 INCH NPT	94			94	94	94	120	94	94	94	94	94	94	120	120	120
3 INCH NPT 4° ANGLE	100			100	100	100	140	100	100	100	100	100	100	140	140	140
4 INCH NPT (2433)	140						140							140	140	140
4 INCH NPT 4° ANGLE (2433)	194						194							194	194	194
TRV WITH 115 FLANGE	428			428	428	428		428	428	428	428	428	428			
TRV-L WITH 115 FLANGE	740	STD		740	740	740		740	740	740	740	740	740			
MAGNESIUM ANODE W/FLANGE	176			176	176	176			176	176						
ZINC ANODE W/FLANGE	115		STD	115	115	115			115	115						
DIRECT MOUNT FOR VALVE	N/C			N/C	N/C	N/C	N/C	N/C	N/C	N/C	N/C	N/C	N/C	N/C	N/C	N/C

SUCTION TUBE EXTENSIONS

XXX IDENTIFIES SERIES OF MATING
HALE FLANGES

ALL EXTENSIONS MAY BE USED ON LEFT OR RIGHT SIDE OF PUMPS AS
NEEDED. PUMP FLANGE IS ON LEFT SIDE OF ALL ILLUSTRATIONS SHOWN

STANDARD
178-0063-00-0

1/4" NPT DRAIN CONNECTION

OPTIONAL
178-0063-01-0 (CAST IRON)
178-0063-03-0 (BRONZE)

(12) HOLES 7/16
14UNC-28 X 8.25 BC

"A" PANEL WIDTH

24" CENTER LINE OR PUMP COMPARTMENT

(PANEL)

B SUCTION TUBE LENGTH

SUCTION TUBE CENTER LINE

1.3 REF

SUCTION TUBE EXPOSED LENGTH

SUCTION TUBE LENGTH B		TRUCK PANEL WIDTH "A"					
		70"	72"	74"	76"	78"	81"
4"	w/o mIV						
	w/MIV	3.63	2.63	1.63			
6"	w/o MIV	2.25	1.25				
	w/MIV	5.63	4.63	3.63	2.63	1.63	
7"	w/o MIV	3.25	2.25	1.25			
	w/MIV	6.63	5.63	4.63	3.63	2.63	1.63
8"	w/o MIV	5.25	4.25	3.25	2.25	1.25	
	w/MIV	8.63	7.63	6.63	5.63	4.63	3.13

Qflo Plus CAFSPro 140

2009

PUMP MODEL, CAPACITY, RATIO, DRIVE UNIT: _____

PRIMER: _____

SUCTION EXTENSION: _____

MIV: _____

TUBE: _____

CAP: _____

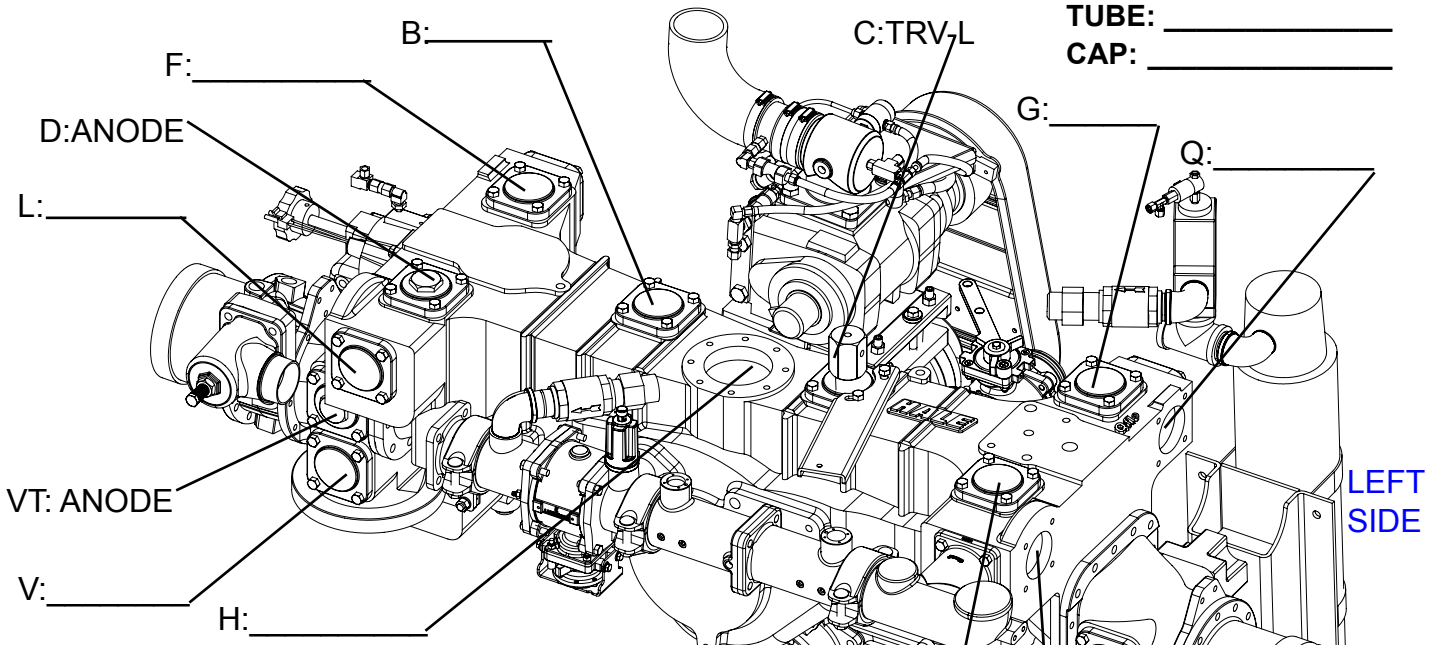

LEFT SIDE

SUCTION EXTENSION: _____

MIV: _____

TUBE: _____

CAP: _____

FRONT

SHIFT: VPS
W/CONTROL

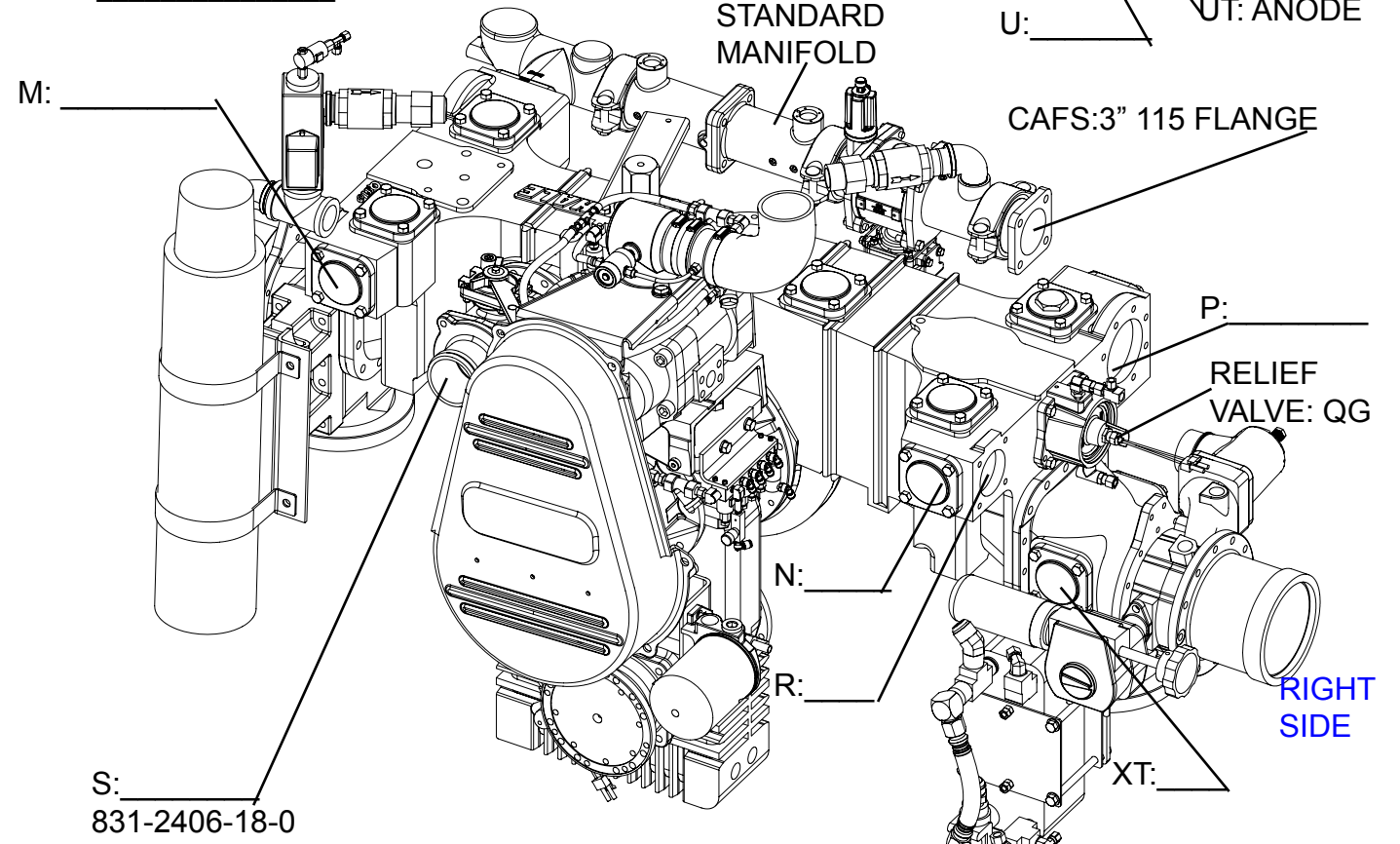

RIGHT SIDE

S: 831-2406-18-0

REAR

ALL CAFSPRO AND FOAMLOGIX OPTIONS ARE SUBJECT TO SCHEDULE "E" DISCOUNTS.

CAFSPRO System

Please Note: All CAFSPRO and foam system component pricing is subject to schedule E discount.

Operator panel (For valve orientation): Top Side

Pump compartment width (from inside operator panel to inside officer side panel): _____ Inches

CAFSPRO Manifold Selection

NOTE: Manifold flow rating refers to rated capacity for all manifold discharges combined during water operations.

STANDARD

<input type="checkbox"/> 500 GPM manifold with 3 inch 115 Hale flange connection (as shown on page 4)	P/N 546-2580-03-0	\$37,360
--	-------------------	----------

OPTIONAL MANIFOLDS

<input type="checkbox"/> 2 each 2 inch Hale SVS Valve connections	P/N 178-0850-01-0	\$ 724
<input type="checkbox"/> 1 each 2 inch and 1 each 2-1/2 inch Hale SVS Valve connection	P/N 178-0850-02-0	\$ 740

Standard CAFSPRO system includes the following:

- 140 CFM rotary screw air compressor mounted and driven by the pump gearbox
 - o Air pressure regulator assembly integrated into compressor
- Oil reservoir/separator tank mounted to pump and plumbed
- Water to oil heat exchanger mounted to pump and plumbed
- Stainless steel manifold assembly mounted on pump and tested
 - o 2 stainless steel water/foam solution check valves
 - o Hale 115 Flange connection for CAFS discharges
 - o Water flow sensors and pressure transducers
 - o Foam and air injection check valves installed
 - o 4 stage Hale X mixer installed
 - o ARC valve and operating cylinder
 - o Complete CAFSPRO wiring harness (mounted and tested)
 - o FoamLogix flowsensor cable
- (2) Air operated 6-port drain valves
 - o (1) Automatically drains CAFSPRO manifold
 - o (1) Pump drain
- Operating cylinder for tank to pump valve (Mounted, adjusted and tested)

The following components are shipped loose with the Hale CAFSPRO system:

- CAFSPRO digital display
- FoamLogix digital display
- 4-1/2 inch duplex master pressure gauge sub-assembly
- 2 Operation manuals
- 2 Installation manuals
- 1 Installation poster
- Hale CAFSPRO delivery and operation program at end user facility (One day (6 hours) training within continental US)

Oflo Plus CAFSPro 140 2009

ALL CAFSPRO AND FOAMLOGIX OPTIONS ARE SUBJECT TO SCHEDULE "E" DISCOUNTS.

FOAMLOGIX MINIMUM REQUIRED STANDARD CONFIGURATION

The FoamLogix foam system required with the CAFSPro system is configured for a single foam tank system with the NO FLUSH option.

Required with the standard CAFSPro system are:

FoamLogix Model 2.1A	\$4,102
Side mount low tank sensor	\$ 89
No Flush/Single Tank System	N/C
In line strainer/valve assembly	N/C
NOTE: Handles Class A Foam ONLY	

FoamLogix Model 5.0 (12 VDC)	\$7,214
No Flush/Single Tank System	\$ 157
Power filter kit	\$ 198
In-line strainer/valve assembly	\$ 213
Side mount low tank sensor	\$ 89

OR

OPTIONAL FOAMLOGIX 5.0 SYSTEM CONFIGURATION

If a dual foam tank system is specified or other type of strainer or low tank sensor are desired circle price of selection(s) below.

(Only applies for the FoamLogix 5.0 system)

NOTE: A strainer and low tank level sensor are required.

NOTE: The CAFSPro system is a 12 VDC system. If a 24 VDC system is required, consult factory for pricing and availability

CONTROL CABLE		
6 PIN EXTENSION	QTY	PRICE EACH
6.6 FEET		85
16.4 FEET		117

STRAINERS	
FOAM CONCENTRATE STRAINER	
	TANK A (CLASS A)
FS15 STRAINER	573
FS25 STRAINER	783
FOAM CONCENTRATE STRAINER	
	TANK B (CLASS B)
IN-LINE STRAINER/ VALVE ASSEMBLY	213
FS25 STRAINER	783

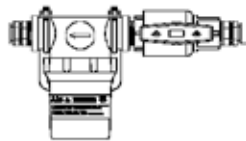

In-Line Strainer/Valve Assembly





Panel Mount FS15 Strainer

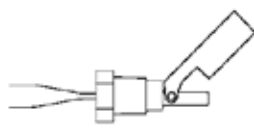

Panel Mount FS25 Strainer

TANK SYSTEMS					
SINGLE TANK SYSTEM			HARNESS EXTENSION		
SELECTOR	INSTRUCTION PLACARD	QTY	PRICE EACH	QTY	PRICE EACH
MST	876	159			31
DUAL TANK SYSTEM			COLOR CODED AIR HARNESS		WIRING HARNESS EXTENSION
SELECTOR	INSTRUCTION PLACARD	QTY	PRICE EACH	QTY	PRICE EACH
ADT (12 VDC)	2237	INCLUDED	78		42
MDT II	1373	159			42

TANK SENSORS		
TANK SENSOR		
	TANK B	
TOP MOUNT SENSOR	358	
SIDE MOUNT SENSOR	89	
BOTTOM MOUNT SENSOR	126	
TANK SENSOR		
	TANK A (CLASS A)	
TOP MOUNT SENSOR	358	
BOTTOM MOUNT SENSOR	126	
		
Top Mount Sensor	Side Mount Sensor	Bottom Mount Sensor

PART NUMBER	ITEM DESCRIPTION	WEIGHT LBS (KG)	LIST PRICE
108-0650-00-0	Air to Oil Auxillary Cooler Standby cooler is recommended for high ambient temperature environments where water temperatures are high. Auxillary cooler prevents pump or compressor overheat during standby conditions when no water is flowing. Ships loose for OEM mounting	35(16)	2,199
115-1301-50-0	X-Mixer Kit X-Mixer kit consists of (4) patented Hale X-Mixers and seals for use on portable deluge guns and other short hose line discharges.	8 (3.6)	238
546-2730-10-0	Auto Tank fill system 2-1/2" : victaulic x Vicatulic (826-0808-31-3 Valve) Shipped loose (Includes panel controls, Class 1 master tank level gauge, Pressure Transducers, Installation Harnesses)		6,100
546-2730-20-0	Auto Tank fill system 3" : victaulic x Vicatulic (831-0808-31-3 Valve) Shipped loose (Includes panel controls, Class 1 master tank level gauge, Pressure Transducers, Installation Harnesses)		6,300
546-2730-30-0	Auto Tank Fill System - for use with Fill Thief, 90o Vic x Vic - 2.5" Valve (includes panel controls, Class 1 Master Tank Tank Level Gauges, Pressure transducers, installation harnesses) (826-1008-31-9)		6,100
546-2770-00-0	Tank to pump air override (Installed) (Required if manual tank valve operator linkage not provided)		903
	Additional consecutive days (6 hours) of Delivery and Operation Training		\$1500/day/net

* A **minimum** of a manual direct booster tank fill valve is required with CAFS 140. Autofill is recommended.

CAFS 140 Class 1 Stainless Steel Manifold Configuration

The stainless steel manifold assembly includes stainless steel check valves and stainless steel motionless mixers in addition to flow sensors and connections for air and foam injection.

Standard CAFSPro 140 manifold outlet is 3 inch Hale 115 Flange

Optional CASFPro 140 Manifolds:

- 2 each 2 inch Hale SVS Valve Flange
- 1 each 2 inch and 1 each 2-1/2 inch Hale SVS Valve Flange

Optional CAFSPro 140 manifolds are supplied with Hale SVS valve connection flanges on the outlets. Using current SVS Valve price list and configuration guide select valve configurations for designated outlets. Provide configured valve part number in blank provided next to outlet. CAFSPro 140 manifold valves will be added to sales order as separate line items subject to schedule E discount.

NOTE ABOUT HALE SVS VALVE CONFIGURATION FOR CAFSPRO MANIFOLD MOUNTING - The inlet side adapter for the valve is included as part of the manifold. To configure the valves for the manifold, the inlet section "XX" will show in the valve part number as "00", i.e. "825-0009-06-0.

The part number shown is a 2-1/2" valve mounted on CAFS 140 manifold with 45° Victaulic swivel outlet and long remote control lever actuator. Actuator position is dependent on whether application is top or side operation panel.

CONFIGURE CAFSPRO MANIFOLD USING ILLUSTRATIONS ON FOLLOWING PAGES.

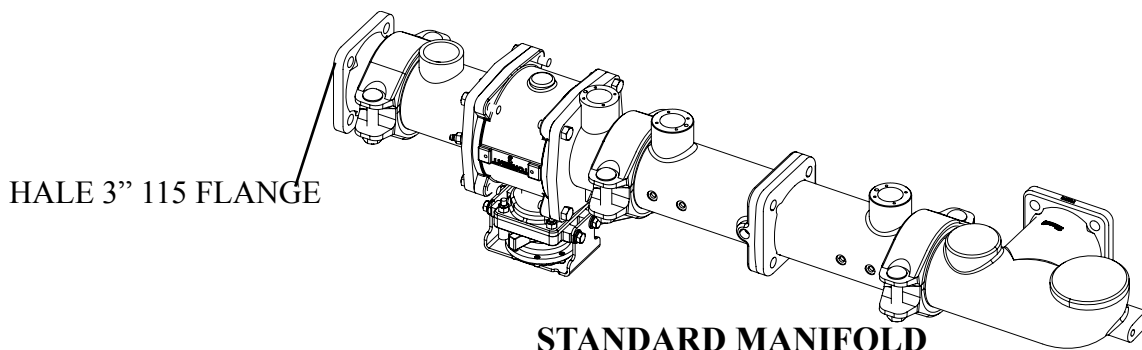

HALE 3" 115 FLANGE

STANDARD MANIFOLD

2 EACH 2" HALE VALVE FLANGE

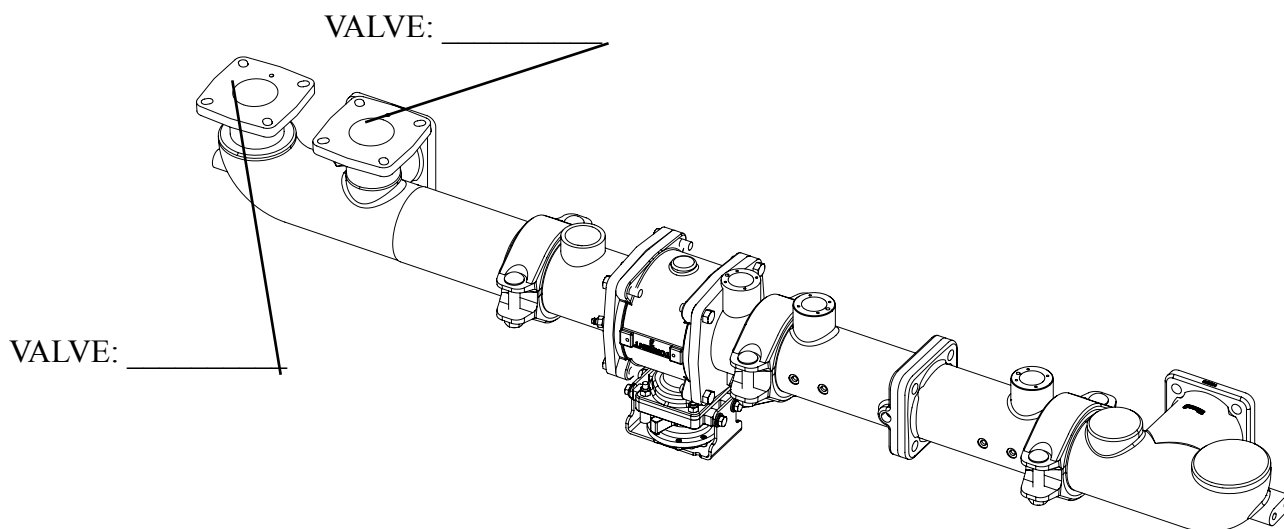

VALVE: _____

VALVE: _____

OPTIONAL MANIFOLD #1

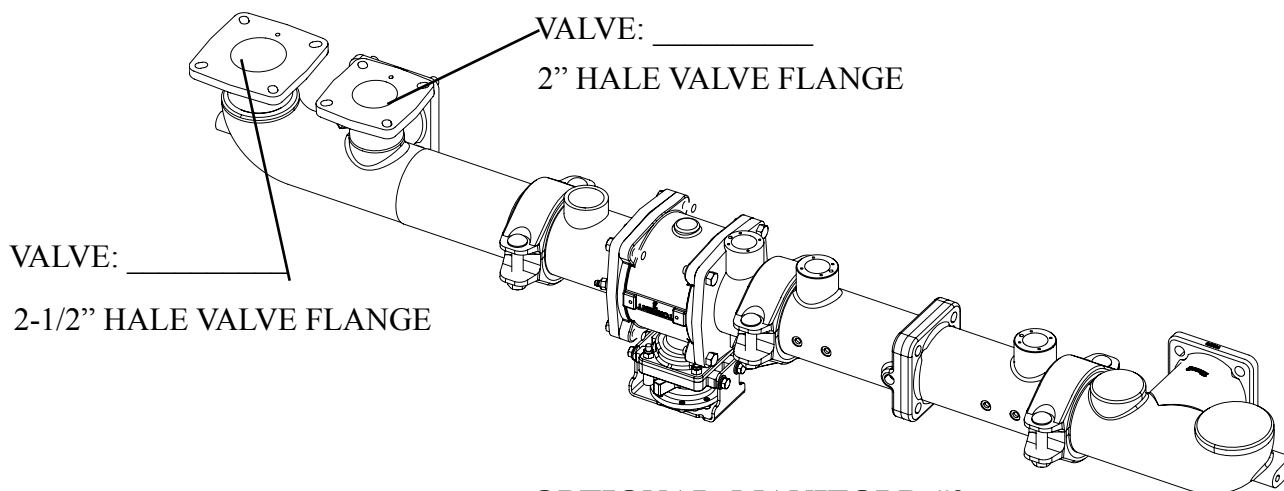

VALVE: _____

2" HALE VALVE FLANGE

VALVE: _____

2-1/2" HALE VALVE FLANGE

OPTIONAL MANIFOLD #2



Hale Products, Inc. A Unit of IDEX Corp. 700 Spring Mill Avenue Conshohocken, PA 19428 USA
TEL: 610/825-6300 1-800/220-HALE FAX: 610/825-9615 www.haleproducts.com