

CUSTOMER ORDER SPECIFICATION FOR HALE 20FS-M FIRE PUMP

Customer Name: _____ Customer P.O. NO.: _____
 Order Prepared By: _____ Hale Customer NO.: _____ Date: _____
 Fire Dept. Name: _____ City: _____ State: _____
 Requested Delivery Date: _____ Max. Elevation for Pump Test: _____ FT
 Reference Specifications: _____

Engine: Mfr: _____ Model: _____ Horsepower: _____ @ _____ RPM
 Full Load Governed RPM: _____ Peak Torque: _____ LB/FT @ _____ RPM
 Application confirmed with: (for applications not on list) _____

1. Pump Model :

20FS(X)-M \$6,322
 NOTE: (X) Indicates Pump Ratio Selected

2. Pump Ratio (Circle Desired Ratio): N/C

| RATIO | MODEL |
|-------|---------|
| 2.00 | 20FS2-M |
| 2.83 | 20FS3-M |
| 3.94 | 20FS4-M |
| 4.93 | 20FS5-M |

3A. Flywheel Housing Options (Check one box):

- Direct Mount to SAE #4 or #5 Flywheel Housing N/C
- SAE #3 to #4 Adapter \$1688

FOR ADDITIONAL OR LOOSE ACCESSORIES, VALVES, FLANGES, SEE SEPARATE ACCESSORY PAGE PRICE LIST AND ATTACH TO PUMP ORDER

3B. Drive Disc, 1-3/8 x 10 Spline

- SAE #7-1/2 Elastomeric (005-0600-03-0) \$2925
- SAE #8 Spring \$2425
- SAE #10 Spring \$ 270
- SAE #11-1/2 Spring \$ 270
- SAE #6-1/2 Elastomeric \$2400
- SAE #10 Elastomeric \$ 966
- SAE #11-1/2 Elastomeric \$ 966

Note: Spring drive disc are for gasoline or 2-cycle diesel engines only. Elastomeric Disc requires a SAE #4 or larger engine bellhousing

4. Gearbox Cooler (Check One Box):

- NONE N/C
- PROVIDED \$ 275

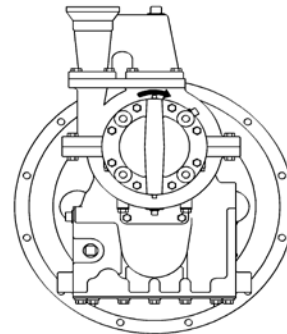

NOTE: Engine Application data and compatibility is the responsibility of the purchaser.

VOLUTE POSITION (Circle Position Desired)

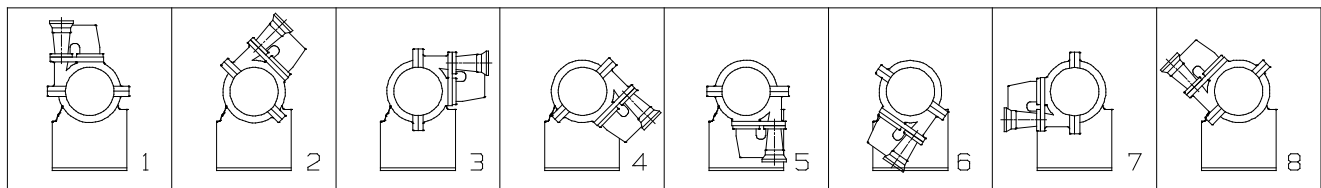

SPECIFY ON ORDER THE DISCHARGE POSITION DESIRED.

| | | SAE FLYWHEEL DIMENSIONS | | | | |
|---|------|-------------------------|---------------|---------------|---------------|---------------|
| | | 11-1/2 CLUTCH | 10 CLUTCH | 8 CLUTCH | 7-1/2 CLUTCH | 6-1/2 CLUTCH |
| A | NO. | 8 EQUAL SPACE | 8 EQUAL SPACE | 8 EQUAL SPACE | 8 EQUAL SPACE | 6 EQUAL SPACE |
| | SIZE | 3/8 - 16 | 3/8 - 16 | 3/8 - 16 | 5/16 - 18 | 5/16 - 18 |
| B | | 13.125 | 11.625 | 9.625 | 8.750 | 7.875 |
| C | | 13.875 | 12.375 | 10.375 | 9.500 | 8.500 |
| D | | 1.56 | 2.12 | 2.44 | 1.19 | 1.19 |

| SAE FLYWHEEL HOUSING DIMENSIONS | | | |
|---------------------------------|------|----------|----------|
| | | NO. 4 | NO. 5 |
| E | NO. | 12 | 8 |
| | SIZE | 3/8 - 16 | 3/8 - 16 |
| F | | 14.25 | 12.375 |
| G | | 15.00 | 13.125 |

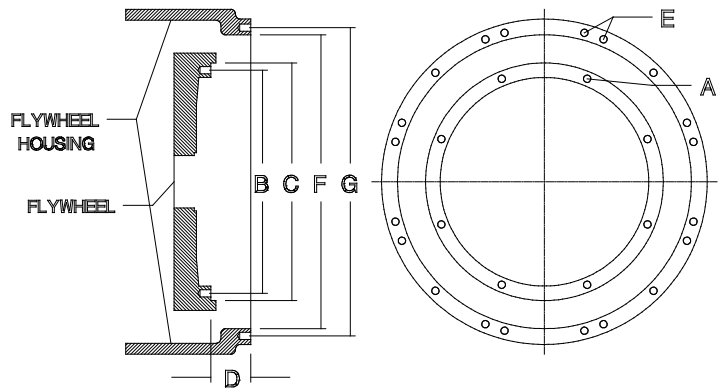

NOTE: Flywheel and bell housing must conform to SAE standards to ensure proper fit and function.



Hale Products, Inc. A Unit of IDEX Corp. 700 Spring Mill Avenue Conshohocken, PA 19428 USA
 TEL: 610/825-6300 1-800/220-HALE FAX: 610/825-9615 www.haleproducts.com

Class 1 A Unit of IDEX Corp. 607 NW 27th Avenue Ocala FL 34475 USA
 Tel: 352-629-5020 800-533-3569 Fax: 352-629-2902 www.class1.com

NOTE: Hale reserves the right to make improvements in design and materials and changes in price without notice
 ALL PRICES ARE U.S. DOLLARS F.O.B. CONSHOHOCKEN, PA 1948
 Bulletin 926-2009, Sheet 2 of 2, © 2009 Hale Products Inc, Printed in USA