

# 5 CHANNEL WALL SWITCH

**98GC661B**

**INSTALLATION AND PAIRING GUIDE**

**REV.07242015**



  
**GIRARD SYSTEMS®**

**RV AWNING PRODUCTS**

1361 CALLE AVANZADO, SAN CLEMENTE, CA 92673 (800) 382-8442 FAX (949)276-5500

[www.girardrv.com](http://www.girardrv.com)



Girard Systems awnings may be operated in light wind and rain conditions. When periods of heavy rain and or high wind are expected the awning must be closed. Never leave the awning open and unattended.

**Damage caused by wind and rain is not covered by warranty.**

All awnings must be closed prior to moving the vehicle for any reason. As an extra safety precaution a visual check that every awning is fully closed is required.

**Damage caused by failure to comply with these instructions is not covered by warranty.**

Before using your awning, ensure that the area into which the awning will be deployed is free of obstructions (Trees, walls, pillars, posts, other vehicles etc.)

**Damage caused by collisions with any of the above or similar is not covered by warranty.**

Before using your awning make sure that all of your electrical circuits are operating correctly. Recreational Vehicles can generate AC power from three separate sources. The electrical system transfer switch in your vehicle will select power for the awning as follows:

**Shore Power** – if connected;

**Generator Power** – if the generator is running;

**Inverter Power** – batteries must be charged for inverter operation.

Girard Systems awnings are supplied with an electric motor appropriate to the product.



---

# **CONTENTS**

The G-Link System .....	3
Product Description .....	4
Setting time and date .....	5
Installation .....	6
Programming .....	7
GC136 AC Motor Controller .....	7
GC274A / GC274B AC motor Controllers .....	8
98GC74 AC Motor Controller .....	9
GC732G DC Motor Controller .....	10
GC1146C DC Motor Controller .....	11

## **THE G-LINK SYSTEM**

The G-Link motors and control modules provided by Girard Systems communicate by use of RF signals on a frequency of 433.92 MHZ. This eliminates the need for wiring and the drilling of holes in the vehicle. These components must be electronically matched or paired before use. This is usually done at the Girard Systems factory. Should the need arise for the user to pair a device with the motor controller they must refer to the appropriate manual for the devices applicable to their particular installation.



## **PRODUCT DESCRIPTION**

The 98GC661B is a 5 channel RF transmitter, powered by two 3v Lithium batteries (CR2032) designed to control a single awning by means of a 6 button control pad as seen in the picture below.



The faceplate can be removed easily by holding the module at the left and right edges firmly in one hand and push the STOP and P2 buttons with two fingers of your other hand. The picture below shows how the batteries must be inserted.





## SETTING TIME AND DATE

The 98GC661B not only controls the awning but functions as a 24 hour clock and a 7 day calendar.

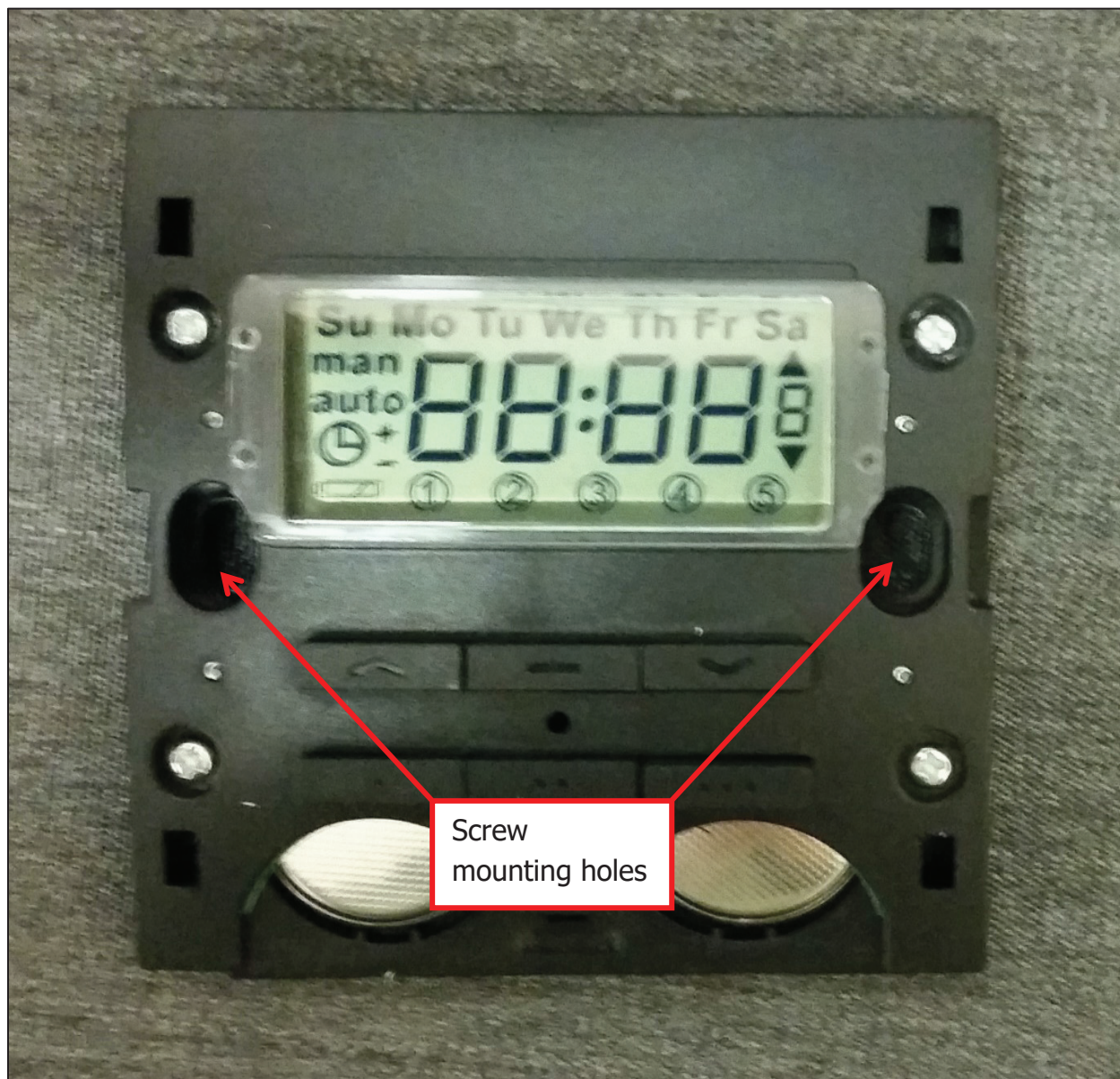

When the battery tray is inserted the display will light up as in the photograph above, then it will default to Mon 10:00. Replace the faceplate, then;

- 1) Press and hold the CH button until the hour starts to flash.



- 2) Set the hour using the IN and OUT buttons.
- 3) Press the CH button once and the minute will start to flash.
- 4) Set the minutes using the IN and OUT buttons.
- 5) Press the CH button once and the day will begin to flash.
- 6) Set the day using the IN and OUT buttons.
- 7) Press and hold the CH button until the selected time and day are displayed but NOTHING is flashing.
- 8) Press the CH button one final time and the : between the hours and minutes will begin to flash, this indicates that the clock is set and running.

## **INSTALLATION**

The screw holes indicated in the picture on page 5 are the only ones to be used when mounting the module. Do NOT drill any other holes in this module as this will damage the circuit board and render the module useless. Screws are provided with the module for this purpose. The 98GC661B has an operating range of 100' but should be mounted with as few obstructions as possible between itself and the Motor Controller it is paired with.

## **PROGRAMMING**

The following pages give instructions of how to pair the 98GC661B with various motor controllers. Ensure that you select the correct set of instructions for the motor controller on your vehicle.

### **GC136 AC Motor Controller**



Fig.1



Fig.2

To pair the 98GC661B Wall switch with a GC136 Motor controller follow the steps below.

**Note; When carrying out this part of the procedure each step must be executed within 10 seconds of the previous one or the module will revert to factory settings. It is highly recommended that you read and understand the following sequence before attempting to execute it.**

- 1) Ensure that there is power supplied to the Motor controller.
- 2) Using an appropriate tool press the Program button on the Motor controller. See Fig.1 (The Green LED will start blinking)
- 3) Press the STOP button on the Motor Controller. See Fig.2 ( The Green LED will remain ON)
- 4) Select the desired channel on the wall switch.
- 5) Press the IN button on the Wall switch. (The Green LED will extinguish)
- 6) Press the OUT, STOP and IN buttons on the wall switch to ensure that the Modules have been successfully paired.



## GC274A / GC274B AC motor Controllers

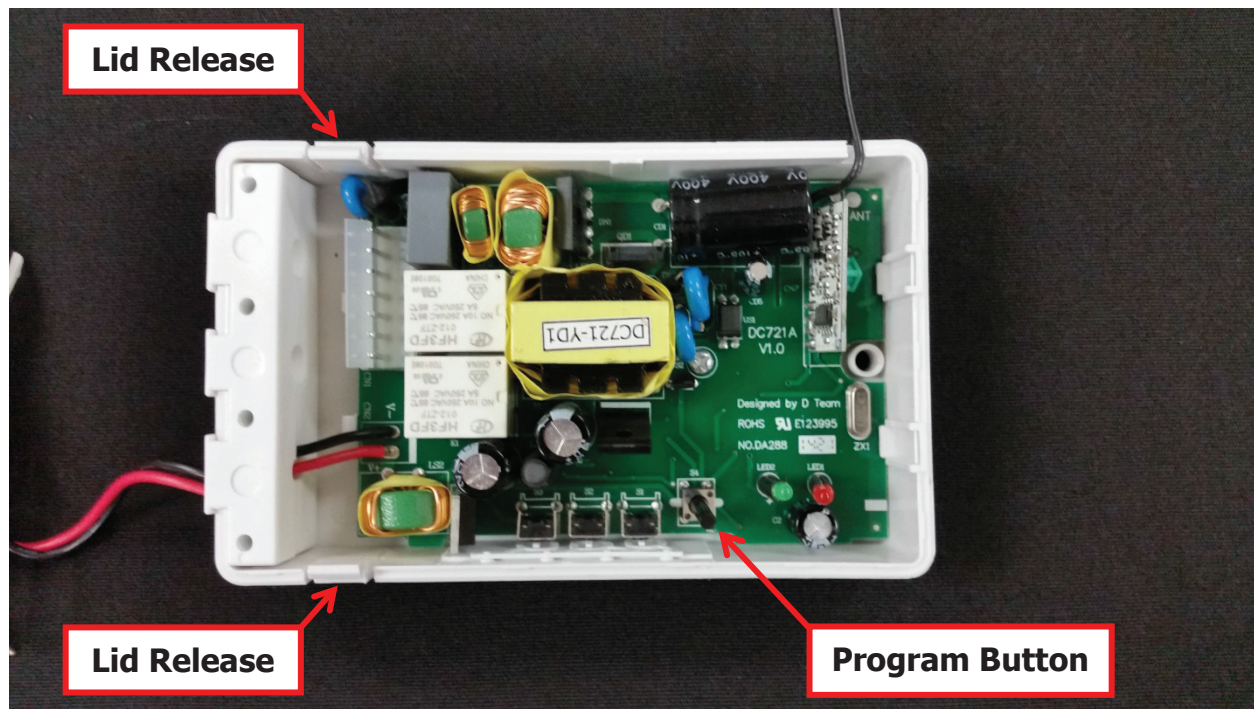

Fig.3

To pair the 98GC661B Wall Switch with a GC274A or GC274B first remove the lid of the motor control module by pressing on the Lid release catches as shown in Fig.3

**Note; When carrying out this part of the procedure each step must be executed within 10 seconds of the previous one or the module will revert to factory settings. It is highly recommended that you read and understand the following sequence before attempting to execute it.**

- 1) Ensure that there is power supplied to the Motor controller.
- 2) Press the Program button on the Motor controller. (The Green LED will start blinking)
- 3) Press the STOP button on the Motor Controller. ( The Green LED will remain ON)
- 4) Select the desired channel on the wall switch.
- 5) Press the IN button on the Wall switch. (The Green LED will extinguish)
- 6) Press the OUT, STOP and IN buttons alternately on the wall switch to ensure that the Modules have been successfully paired.



## **98GC74 AC Motor Controller**

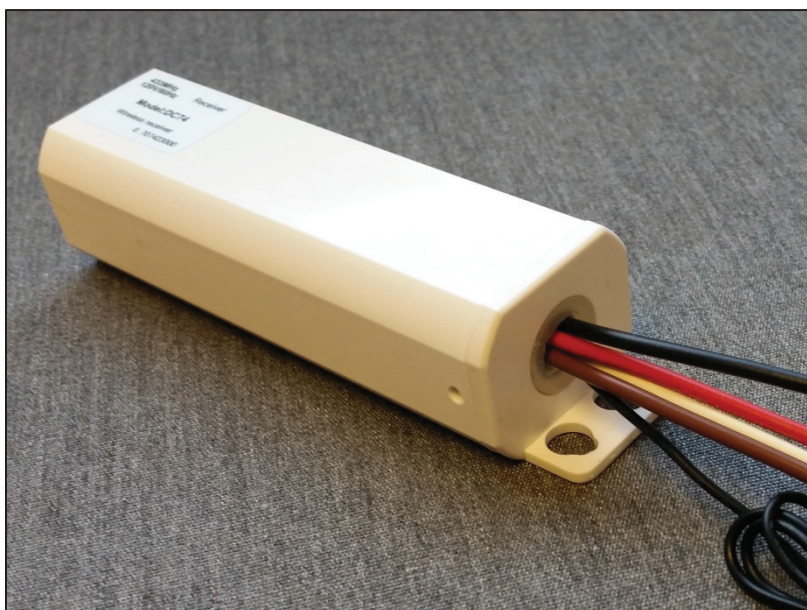

When pairing with the 98GC74 it is advised that the awning to be controlled is manually extended couple of feet to enable the programmer to see if the awning is responding in the correct direction when the buttons on the wall switch are pressed.

**The programming window for this module is only 6 seconds so please ensure that the programming instructions are read and understood before attempting to execute them.**

- 1) Supply power to the motor control module. (It will beep ONCE )
- 2) Press the P2 button on the wall switch TWICE. (The motor controller will beep with each press)
- 3) Select the desired channel on the wall switch.
- 4) Press the IN button on the wall switch. (The awning should retract)

If the awning extends at this point instead of retracting, press the STOP button immediately, then remove the power supply to the motor controller for at least 10 seconds.

Next repeat steps 1 and 2 above then press the OUT button on the wall switch to complete the programming procedure.

Ensure that the awning responds correctly to the wall switch by pressing the OUT, STOP and IN buttons alternately.

## GC732G DC Motor Controller

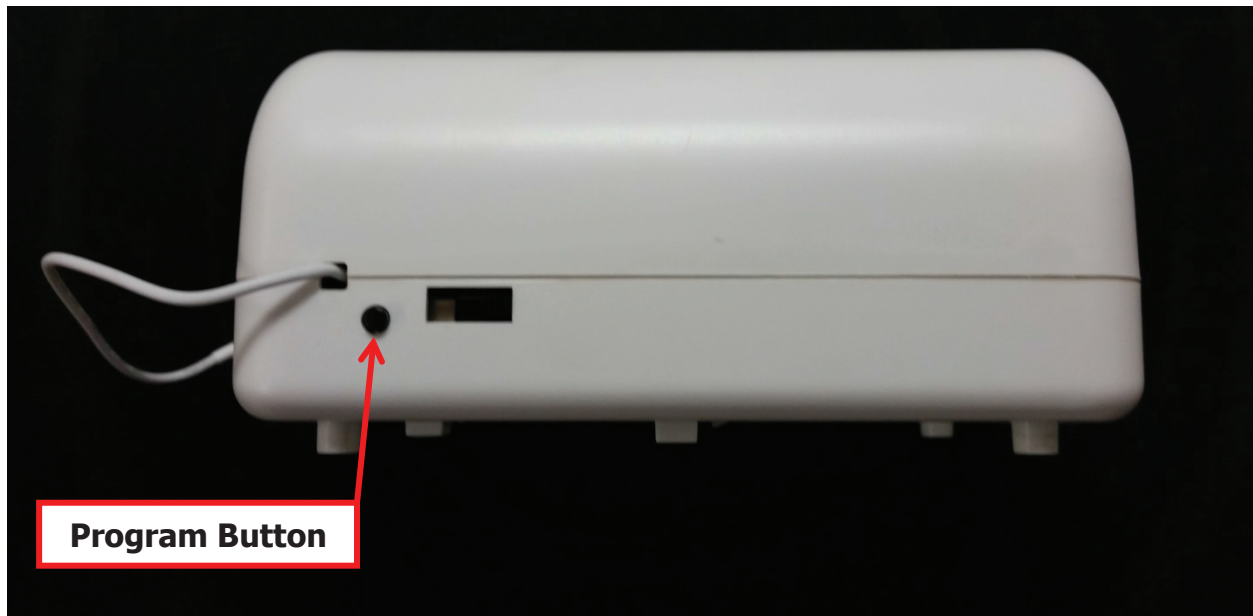

Fig.4

To pair the 98GC661B Wall switch with a GC732G Motor controller follow the steps below.

**Note; When carrying out this part of the procedure each step must be executed within 10 seconds of the previous one or the module will revert to factory settings. It is highly recommended that you read and understand the following sequence before attempting to execute it.**

- 1) Ensure that there is power supplied to the Motor controller.
- 2) Press the Program button on the Motor controller. (The Red LED will start blinking)
- 3) Press the STOP button on the Motor Controller. ( The Red LED will remain ON)
- 4) Select the desired channel on the wall switch.
- 5) Press the IN button on the Wall switch. (The Red LED will extinguish)

Press the OUT, STOP and IN buttons alternately on the wall switch to ensure that the Modules have been successfully paired.



## GC1146C DC Motor Controller



To pair the 98GC661B Wall switch with a GC1146C Motor controller follow the steps below.

- Identify the Remote handset which operates the DC Motor controller for the awning that the wall switch is to operate. This is likely to be either a 98GC1063 Single channel, or a 98GC1029 Multi channel handset.
- Fully extend the awning to ensure smooth operation, and then retract the awning leaving it partially open (about 3 feet).
- Locate the P2 Button on the back of the handset.

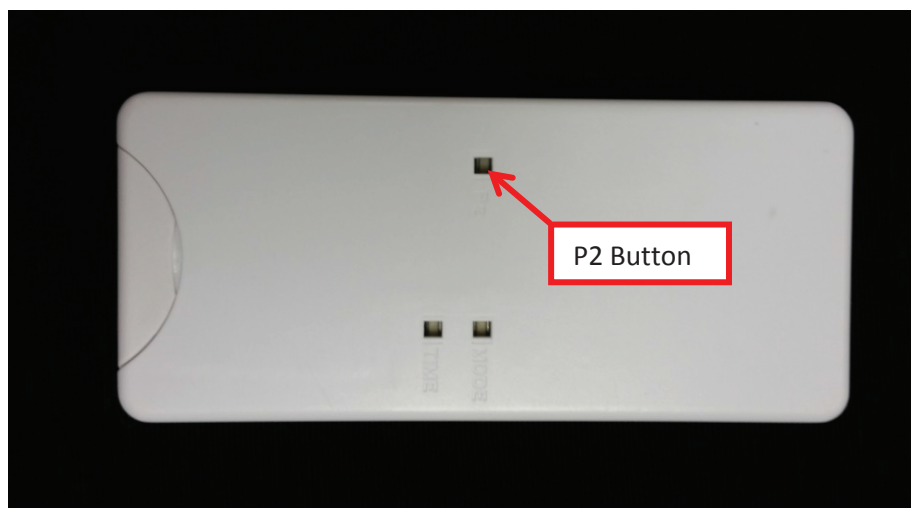



---

**Note; When carrying out this part of the procedure each step must be executed within 10 seconds of the previous one or the module will revert to factory settings. It is highly recommended that you read and understand the following sequence before attempting to execute it.**

- 1) Supply power to the Motor controller. (The GC1146C will emit a soft beep)
- 2) Using an appropriate tool press the P2 button on the back of the Handset TWICE. ( The GC1146C will Beep with each press)
- 3) Select the desired channel on the wall switch.
- 4) Press the P2 button on the wall switch ONCE (The GC1146C will beep again)
- 5) Press the IN button on the wall switch and verify that the awning moves in the desired direction.

If the awning extends at this point instead of retracting, press the STOP button immediately, then remove the power supply to the motor controller for at least 10 seconds.

Next repeat steps 1, 2 and 3 above then press the OUT button on the wall switch to complete the programming procedure.

Ensure that the awning responds correctly to the wall switch by pressing the OUT, STOP and IN buttons alternately.

For queries or assistance with programming any of your G-Link devices please call Girard Systems TOLL FREE on 800-382-8442 between 7:30am and 3:30pm P.S.T.