

Owner's Manual & Safety Instructions

Save This Manual Keep this manual for the safety warnings and precautions, assembly, operating, inspection, maintenance and cleaning procedures. Write the product's serial number in the back of the manual near the assembly diagram (or month and year of purchase if product has no number). Keep this manual and the receipt in a safe and dry place for future reference.

REV 16c

CHICAGO  **ELECTRIC** **WELDING**

WELDING CART



Visit our website at: <http://www.harborfreight.com>
Email our technical support at: productsupport@harborfreight.com

ITEM 65939

When unpacking, make sure that the product is intact and undamaged. If any parts are missing or broken, please call 1-888-866-5797 as soon as possible.

Copyright© 2008 by Harbor Freight Tools®. All rights reserved.

No portion of this manual or any artwork contained herein may be reproduced in any shape or form without the express written consent of Harbor Freight Tools. Diagrams within this manual may not be drawn proportionally. Due to continuing improvements, actual product may differ slightly from the product described herein.

Tools required for assembly and service may not be included.

WARNING

**Read this material before using this product.
Failure to do so can result in serious injury.
SAVE THIS MANUAL.**

Important SAFETY Information

Assembly Precautions

1. Assemble only according to these instructions. Improper assembly can create hazards.
2. Wear ANSI-approved safety goggles and heavy-duty work gloves during assembly.
3. Keep assembly area clean and well lit.
4. Keep bystanders out of the area during assembly.
5. Do not assemble when tired or when under the influence of drugs or medication.
6. To prevent explosion, do not fill the tires above 40 PSI.

Use Precautions

1. Avoid working alone. If an accident occurs, an assistant can get help.
2. This product is not a toy. Do not allow children to play with or near this item.
3. Use as intended only.
4. Always store acetylene and oxygen tanks away from flammable materials and heat sources.
5. Inspect before use; check welds for cracks.
6. Wear the proper face mask and gloves for welding purposes.
7. Make sure tanks are securely strapped to the cart.
8. Store and use this cart only on flat and level surfaces.
9. After welding, make sure gas valves are securely tightened.
10. Read and understand the warnings and instructions provided by the manufacturer of the welding equipment being used.
11. Maintenance should be performed by a qualified technician.
12. Maintain product labels and nameplates. These carry important safety information. If unreadable or missing, contact Harbor Freight Tools for a replacement.

Assembly Instructions



Read the **ENTIRE IMPORTANT SAFETY INFORMATION** section at the beginning of this document including all text under subheadings therein before set up or use of this product.

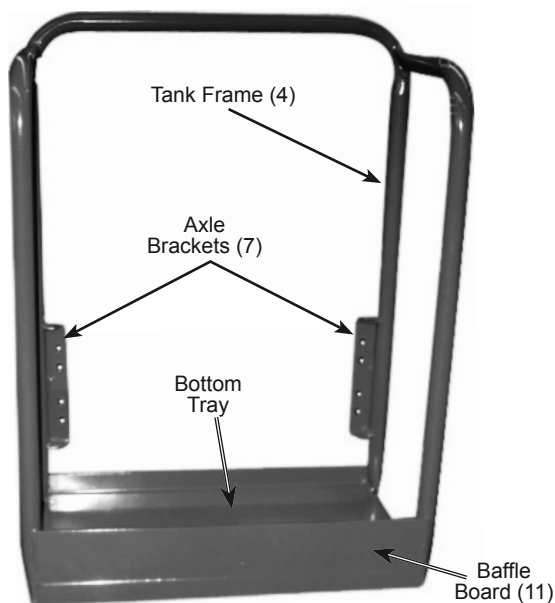

Figure A

1. Start with the welded Tank Frame (4) as this is where everything else attaches.

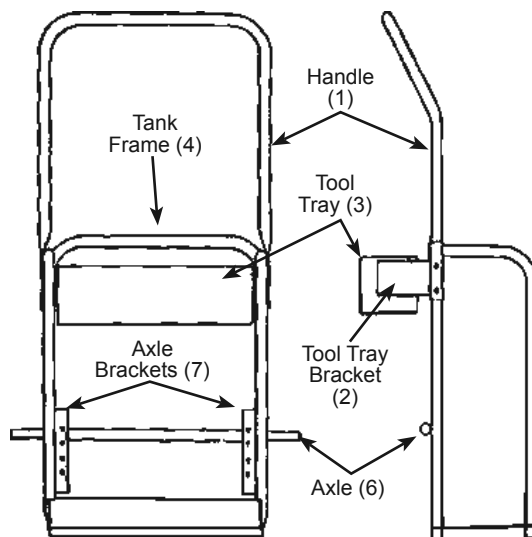

Figure B

2. Line up the holes of the Handle (1) and the Tool Tray Bracket with the holes at the upper sides of the Tank Frame (4).

3. Fit two Screws (9) through the holes in the Handle (from the outside in), Tank Frame side, and the Tool Tray Brackets on the inside of the Tank Frame, and screw on two Washers and Nuts.
4. Repeat for the other side.
 - a. When attaching the second Tool Tray Bracket, slide the Tool Tray (3) onto the metal pegs on the Brackets. These Brackets hold the Tool Tray in place.
 - b. The Tool Tray should be able to swing freely as the cart is tilted.
5. Slide the Wheels (5) onto the Axle ends and secure in place with washers and split keys.
6. The Axle (6) is attached to the back-bottom of the Tank Frame with two U-Bolts and four washers and nuts onto the Axle Bracket (7).
 - a. There are two mounting height available:
 - Upper mounting position - The Wheels should be slightly off the ground when the Cart is standing straight up.
 - Lower mounting position - The wheels are always on the ground supporting the cart.
7. Check all screws and nuts making sure they are tightly fastened and secure.

Maintenance

1. Periodically check welds for cracks and for loose parts or damage.
2. Check wheel tightness and tire pressure. To prevent explosion, do not fill the tires above 40 PSI.
3. Lubricate wheels if they begin to bind or squeak.
4. Keep dry and free of rust.

Storage and Safety Precautions

1. Store tanks away from heat and ignition sources.
2. Consult gas supplier on safest way to transport and store gases.
3. Cart is designed for a maximum of 48" tanks.
4. Store and use on flat, level, hard surface.
5. When done welding, check that all gas valves are closed tightly.

Parts List

Part	Description	Qty.
1.	Handle	1
2.	Tool Tray Bracket	2
3.	Tool Tray	1
4.	Tank Frame	1
5.	Wheels (40 PSI)	2
6.	Axle	1
7.	Axle Bracket	2
8.	U-Bolt	2
9.	Screws (2" x 3/16")	4
10.	Hex Screw	2
11.	Baffle Board	1

Record Serial Number Here: _____

Note: If product has no serial number, record month and year of purchase instead.

Note: Some parts are listed and shown for illustration purposes only, and are not available individually as replacement parts.

PLEASE READ THE FOLLOWING CAREFULLY

THE MANUFACTURER AND/OR DISTRIBUTOR HAS PROVIDED THE PARTS LIST AND ASSEMBLY DIAGRAM IN THIS DOCUMENT AS A REFERENCE TOOL ONLY. NEITHER THE MANUFACTURER OR DISTRIBUTOR MAKES ANY REPRESENTATION OR WARRANTY OF ANY KIND TO THE BUYER THAT HE OR SHE IS QUALIFIED TO MAKE ANY REPAIRS TO THE PRODUCT, OR THAT HE OR SHE IS QUALIFIED TO REPLACE ANY PARTS OF THE PRODUCT. IN FACT, THE MANUFACTURER AND/OR DISTRIBUTOR EXPRESSLY STATES THAT ALL REPAIRS AND PARTS REPLACEMENTS SHOULD BE UNDERTAKEN BY CERTIFIED AND LICENSED TECHNICIANS, AND NOT BY THE BUYER. THE BUYER ASSUMES ALL RISK AND LIABILITY ARISING OUT OF HIS OR HER REPAIRS TO THE ORIGINAL PRODUCT OR REPLACEMENT PARTS THERETO, OR ARISING OUT OF HIS OR HER INSTALLATION OF REPLACEMENT PARTS THERETO.

Limited 90 Day Warranty

Harbor Freight Tools Co. makes every effort to assure that its products meet high quality and durability standards, and warrants to the original purchaser that this product is free from defects in materials and workmanship for the period of 90 days from the date of purchase. This warranty does not apply to damage due directly or indirectly, to misuse, abuse, negligence or accidents, repairs or alterations outside our facilities, criminal activity, improper installation, normal wear and tear, or to lack of maintenance. We shall in no event be liable for death, injuries to persons or property, or for incidental, contingent, special or consequential damages arising from the use of our product. Some states do not allow the exclusion or limitation of incidental or consequential damages, so the above limitation of exclusion may not apply to you. THIS WARRANTY IS EXPRESSLY IN LIEU OF ALL OTHER WARRANTIES, EXPRESS OR IMPLIED, INCLUDING THE WARRANTIES OF MERCHANTABILITY AND FITNESS.

To take advantage of this warranty, the product or part must be returned to us with transportation charges prepaid. Proof of purchase date and an explanation of the complaint must accompany the merchandise. If our inspection verifies the defect, we will either repair or replace the product at our election or we may elect to refund the purchase price if we cannot readily and quickly provide you with a replacement. We will return repaired products at our expense, but if we determine there is no defect, or that the defect resulted from causes not within the scope of our warranty, then you must bear the cost of returning the product.

This warranty gives you specific legal rights and you may also have other rights which vary from state to state.



3491 Mission Oaks Blvd. • PO Box 6009 • Camarillo, CA 93011 • 1-888-866-5797