



# 1 PREPARATION

## Unpacking Your P-touch Labeler

Check that the package contains the followings before using your P-touch labeler.

PT-70 M tape cassette User's Guide

Included items may differ by distribution.

Industry Canada Compliance Statement (Canada Only)  
This Class B digital apparatus complies with Canadian ICES-003.

### Warning

- Do not use the machine in places of high humidity such as bathrooms.
- Do not swallow the cutter stopper.
- Do not get the machine wet, such as by handling it with wet hands or spilling beverages on it.
- Do not disassemble or modify the P-touch labeler/batteries.
- Do not use metallic objects, such as tweezers or a metallic pen, when changing the batteries.
- Do not throw the batteries into fire or expose to heat.
- Remove batteries immediately and stop using the machine if you notice abnormal odor, heat, discoloration, deformation or anything unusual while using or storing it.

### Caution

- Do not touch the edge of the cutter near the print head.
- Remove the batteries if you do not intend to use P-touch labeler for an extended period of time.
- Do not use old and new batteries together or mix alkaline batteries with other type batteries, or set the positive and negative end in the wrong position.
- Do not drop or hit the P-touch labeler.
- Do not press hard on the LCD display.
- Do not put your finger between the covers when you close the back cover.

### General Precautions

- Depending on the location, material, and environmental conditions, the label may unpeel or become irremovable, the color of the label may change or be transferred to other objects. Before applying the label, check the environmental condition and the material.
- Do not use the P-touch labeler in any way or for any purpose not described in this guide. Doing so may result in accidents or damage the machine.
- Use only Brother M tapes with this machine. Do not use tapes that do not have the M mark.
- Only use a soft, dry cloth to clean the labeler; never use alcohol or other organic solvents.
- Use a soft wipe to clean the print head; never touch the print head.
- Do not put any foreign objects into the tape exit slot, etc.
- Do not place the P-touch labeler/battery in direct sunlight or rain, near heaters or other hot appliances, in any location exposed to extremely high or low temperatures (e.g. on the dashboard or in the back of your car), high humidity, or dusty locations.
- Do not apply excessive pressure to the cutter lever.
- Do not try to print if the cassette is empty; it will damage the print head.
- Do not pull the tape while printing or feeding; it will damage the tape and machine.
- When power is disconnected for more than two minutes, all text and format settings will be cleared. Language, unit and clock settings will also be cleared.

# 2 OPERATION

## Power Supply & Tape Cassettes

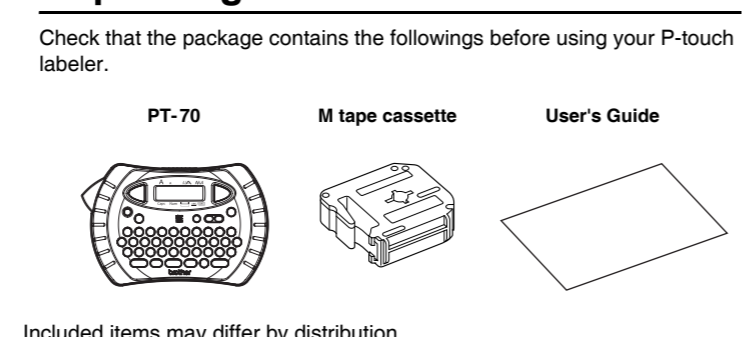

## Initial Setting

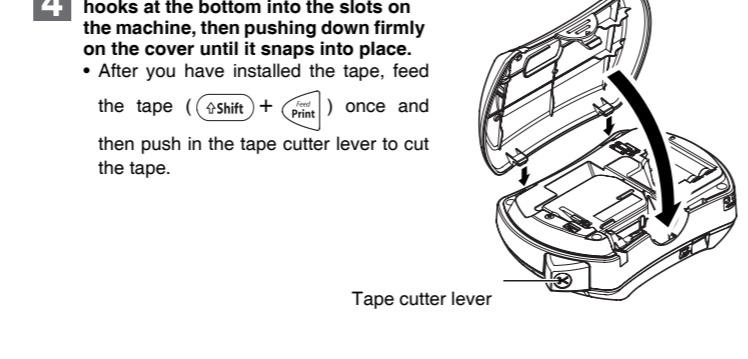
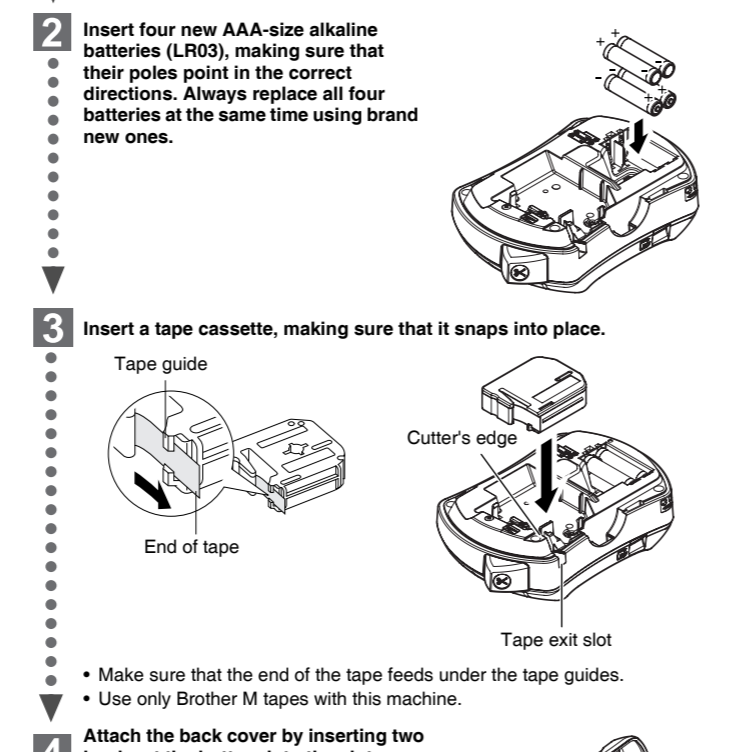
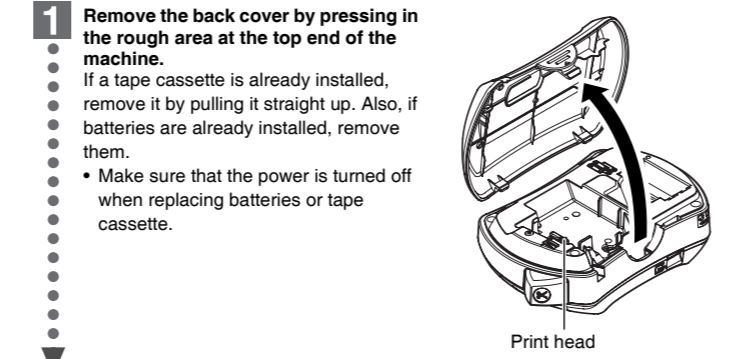

# 3 REFERENCE

## Troubleshooting

Message	Cause/Remedy
Battery	The batteries are weak. Replace them with new ones.
Invalid	Invalid number is selected for Label Length setting.
No Text	• The Print key or Preview key is pressed when no text is entered. • You tried to set Copies (copy printing) when no text is entered.
Line Lmt	Line Limit. You can have up to 2 printable lines. You tried to enter a 3rd line by pressing Enter key.
Full	The maximum number of characters (80 characters) has already been entered.
Text Lmt	Text Limit. The text length exceeds the selected label length or the selected Auto Format setting length.

**What to do when...**

Problem	Solution
The display stays blank after you have turned on the machine.	• Check that the batteries are correctly inserted. • If the batteries are weak, replace them.
Language setting of the machine is incorrect.	• Turn off the machine and then while holding down Shift and R, press L to turn the machine back on. Finally, release Shift and R. • Note: The text and formats in the display are erased. Also, the language, unit and clock settings will be cleared.
The machine does not print, or the printed characters are not formed properly.	• Check that the tape cassette has been inserted correctly. • If the tape cassette is empty, replace it. • Check that the back cover is properly closed.
The setting has cleared on its own.	• The batteries may be weak. Replace them. • When power is disconnected for more than two minutes, all text & formats in the display will be lost. Language, unit and clock settings will also be cleared.
A blank horizontal line appears through the printed label.	• There may be some dust on the print head. Remove the tape cassette and use a dry cotton swab to gently wipe the print head with an up-and-down motion.
The machine has "locked up" (i.e., nothing happens when a key is pressed, even though the machine is on).	• Turn off the machine, and then while holding down Shift and R, press L to turn the machine back on. Finally, release Shift and R. • Note: The text and formats in the display are erased. Also, the language, unit and clock settings will be cleared.
The power turns off when you try to print.	• The batteries may be weak. Replace them.
The tape does not feed properly or the tape gets stuck inside the machine.	• Check that the end of the tape feeds under the tape guides. • The cutter lever is used while printing. Do not touch the cutter lever during printing.
All text and format settings need to be cleared to create a new label.	• Press Backspace key while holding down Shift key, or go into Function mode and select O.

The LCD shows one row of 8 characters; however, the text that you enter can be up to 80 characters in length, which will scroll across the display.

Use Cursor key while holding down Shift key to go to beginning / end of the text.

## Specifications

Item	Specification
Dimensions	6.7" (W) x 4.4" (D) x 2.3" (H) (167 mm (W) x 110 mm (D) x 58 mm (H))
Weight	0.5 lbs. (240 g) (without batteries and tape cassette)
Power supply	Four AAA-size alkaline batteries (LR03)
Tape cassette	Brother M tape (width): 9 mm, 12 mm

- Turn on your machine. Supply power by using four AAA batteries, and then press L.
- Set the language (English/Spanish/French/Portuguese).  
Choose a language with Left Arrow and Right Arrow and press L.
- Set the unit (inch/mm).  
Choose a unit with Left Arrow and Right Arrow and press L.
- Set Date (MM/DD/YY) and Time (hh:mm).  
Example: setting the clock to March 20th 2006, 10:30AM

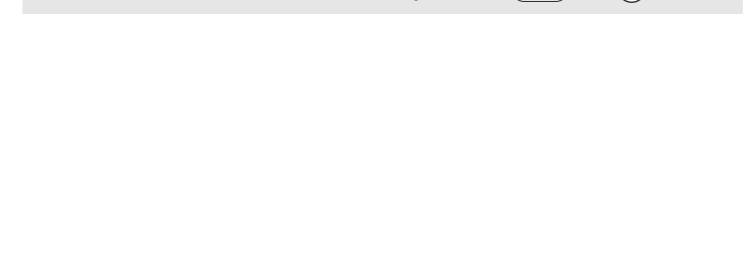

- The machine automatically turns off if no key is pressed within 5 minutes.
- To cancel operations, press C.
- To initialize the P-touch labeler back to factory settings, turn off the machine and then while holding down Shift and R, press L to turn the machine back on. Finally, release Shift and R.

# 1 MAKING TEXT

## Switching Upper Case/Lower Case

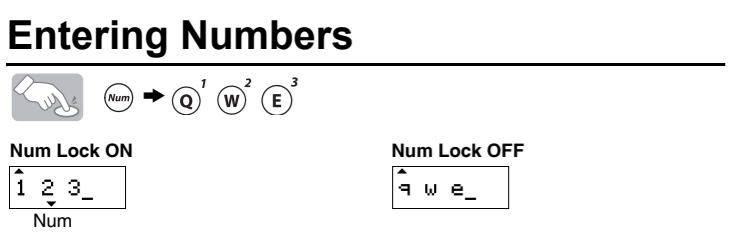
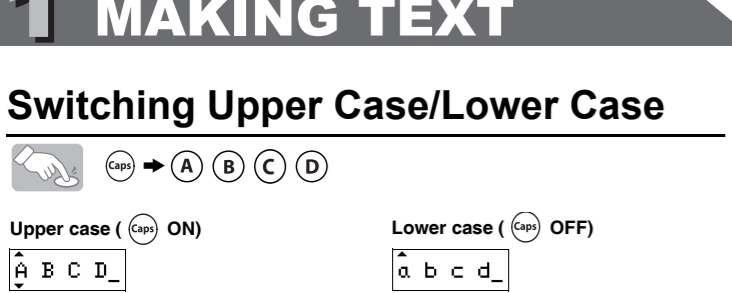

## Entering Symbols

Group	Symbols
1	, : ; ' " . *
2	@ - & _ ~ \ /
3	# % ! ? ! ~ i *
4	+ - x ÷ ± =
5	( ) [ ] < >
6	→ ← ↑ ↓
7	\$ % € £ ¥ ¢ ✓
8	² ³ ◊ ○ ★ ♥ ♪
9	⊙ ☠ ☹ ☺ ☻ ☼ ☽ ☿
10	* ✱ ✲ ✳ ✴ ✵ ✶ ✷ ✸
11	☼ ☽ ☿ ☺ ☻ ☼ ☽ ☿

- To go to the next group, press (Right Arrow).
- To cancel operations, press C.

## Entering Accented Characters

Accented Characters	Accented Characters
A Á Â Ã Ä Å Æ Ā Ā Ā Ā	a á â ã ä å æ ā ā ā ā
C Ç Ć Ć	c ç ć ć
D Ċ Ċ Ċ Ċ Ċ Ċ Ċ Ċ Ċ Ċ	d ċ ċ ċ ċ ċ ċ ċ ċ ċ ċ
E Ē Ē Ē Ē Ē Ē Ē Ē Ē Ē	e ē ē ē ē ē ē ē ē ē ē
G Ğ Ğ Ğ Ğ Ğ Ğ Ğ Ğ Ğ Ğ	g ğ ğ ğ ğ ğ ğ ğ ğ ğ ğ
I İ İ İ İ İ İ İ İ İ İ	i ı ı ı ı ı ı ı ı ı ı
K Ĳ Ĳ Ĳ Ĳ Ĳ Ĳ Ĳ Ĳ Ĳ Ĳ	k ĳ ĳ ĳ ĳ ĳ ĳ ĳ ĳ ĳ ĳ
L Ł Ł Ł Ł Ł Ł Ł Ł Ł Ł	l ł ł ł ł ł ł ł ł ł ł
N Ń Ń Ń Ń Ń Ń Ń Ń Ń Ń	n ń ń ń ń ń ń ń ń ń ń
O Ó Ó Ó Ó Ó Ó Ó Ó Ó Ó	o ó ó ó ó ó ó ó ó ó ó
R Ŕ Ŕ Ŕ Ŕ Ŕ Ŕ Ŕ Ŕ Ŕ Ŕ	r ŕ ŕ ŕ ŕ ŕ ŕ ŕ ŕ ŕ ŕ
S Ś Ś Ś Ś Ś Ś Ś Ś Ś Ś	s ś ś ś ś ś ś ś ś ś ś
T Ħ Ħ Ħ Ħ Ħ Ħ Ħ Ħ Ħ Ħ	t ħ ħ ħ ħ ħ ħ ħ ħ ħ ħ
U Ú Ú Ú Ú Ú Ú Ú Ú Ú Ú	u ú ú ú ú ú ú ú ú ú ú
Y Ý Ý Ý Ý Ý Ý Ý Ý Ý Ý	y ý ý ý ý ý ý ý ý ý ý
Z Ž Ž Ž Ž Ž Ž Ž Ž Ž Ž	z ž ž ž ž ž ž ž ž ž ž

To cancel operations, press C.  
The order of accented characters differ by the selected LCD language.

## Making Two Line Text

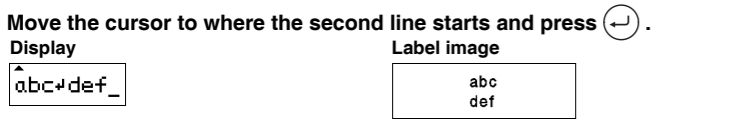

# 2 DESIGNING LABELS

## Setting [Size]

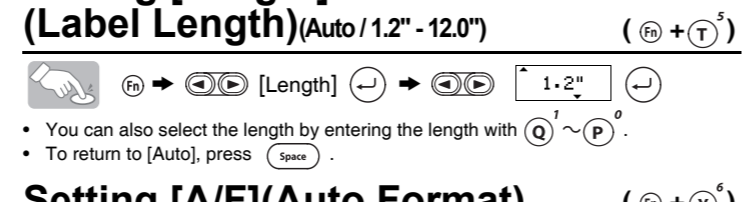
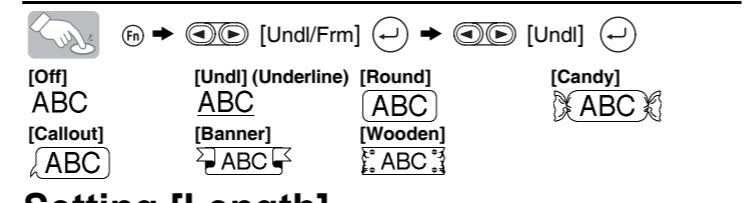
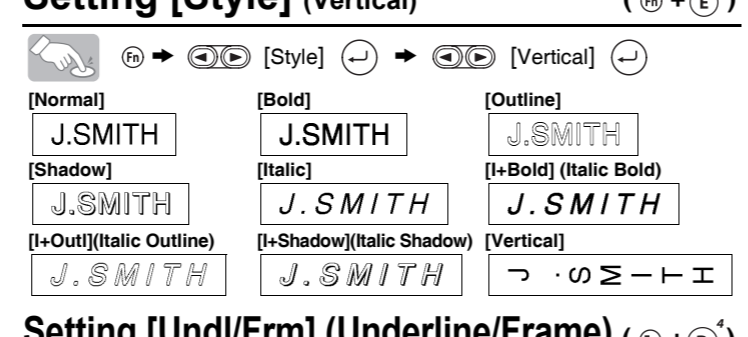
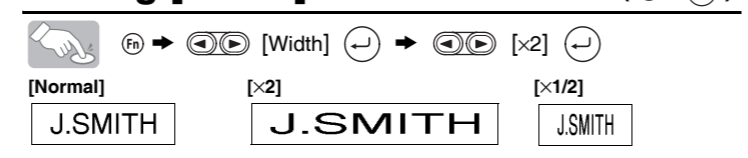
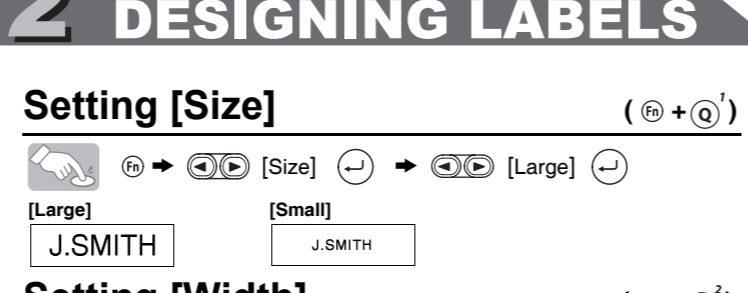

## Setting [A/F](Auto Format)

You can choose label length from five formats to create labels for various applications.

LCD	Application	Length
VCR VHS	Cassette spine	5.5"
MiniDV	Cassette spine	1.6"
Audio	Cassette case spine	3.5"
File Tab	File tab	3.2"
Divider	Divider Tab	1.6"

## To Clear

By pressing the backspace key you will delete a character.  
(To delete a whole line of text, keep pressing the Backspace key)

## To Clear All Text and Settings

Shift + C → AllClear → Clear?

This will not affect Time & Date or language settings.

# 3 PRINTING LABELS

## Text Preview

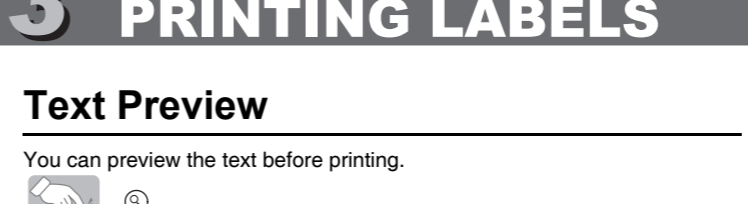

## Feeding (Tape Feed)

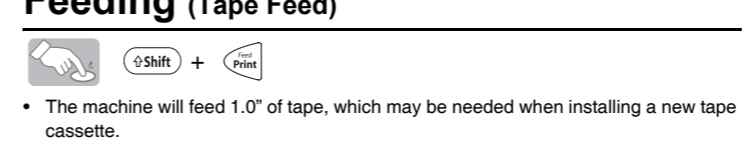

## Printing/Cutting

To cut off the label, push in the tape cutter lever on the upper-left corner of the machine.  
To prevent damage to the tape, do not try to cut while the message "Print" or "Feed" is displayed.

Copies (9 + U)  
You can print up to 9 copies of each label.  
[Copies] [1-9? 5]  
You can also select the number of copies by entering with (Q)~(P).

## COMPLETED LABELS



Peel the printed label from backing and apply the label.

## Removing the Label Backing

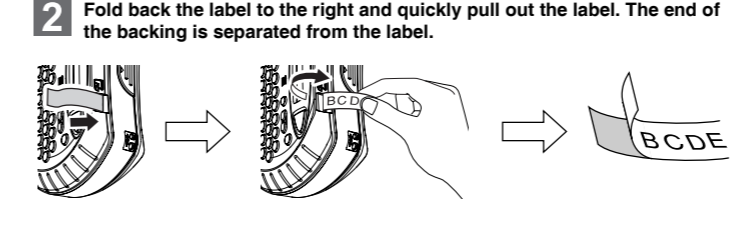

# 4 USEFUL FUNCTIONS

## Time & Date Function

You can add the desired time and date to your text at the touch of a button. 8 Formats are available for printing time and date.  
You can change the number of time/date by changing the clock setting.

To add Time & Date to your text:  
[TimeDate] [3/20/06]

The cursor should be positioned where you wish to insert the time & date.

To select the format of Time & Date:  
[TimeDate] [TimeDate] [Format]

Format	Description	Example (March 20th 2006, 3:30PM)
M/D/Y	Month/ Date/ Year	03/20/06
M/D/Y hm	Month/ Date/ Year time	03/20/06 03:30PM
D/M/Y	Date/ Month/ Year	20/03/06
D/M/Y hm	Date/ Month/ Year time	20/03/06 03:30PM
D.M.Y	Date.Month.Year	20.03.06
D.M.Y hm	Date.Month.Year time	20.03.06 03:30PM
Y-M-D	Year- Month- Date	06-03-20
Y-M-D hm	Year- Month- Date time	06-03-20 03:30PM

To change the Clock Setting:  
Example: setting the clock to March 20th 2006, 10:30AM  
[TimeDate] [TimeDate] [Clock]

Setting Month (MM), Date (DD), Year (YY)  
[MM/01/06] → [03/20/06] → [03/28/YY] → input "06"

Setting Hour (hh) and Minute (mm)  
[hh:00] → [10:30] → [10:30] → [AM]

Select AM/PM with (Left Arrow) and (Right Arrow) and press L.

You can also confirm the figure and move to the next setting by using right cursor key.

## Function Shortcuts

In addition to the basic steps to search for a function, PT-70 provides you with function shortcuts so you can easily jump to a frequently used function just by pressing (F) and the shortcut key shown in the table below.  
To confirm, press (Enter).

Key	Function	Key	Function
Q <sup>1</sup>	Size	Y <sup>6</sup>	Auto Format
W <sup>2</sup>	Width	U <sup>7</sup>	Copies
E <sup>3</sup>	Style	I <sup>8</sup>	Time & Date
R <sup>4</sup>	Underline/Frame	O <sup>9</sup>	All Clear
T <sup>5</sup>	Label Length		